



Maddoxford Park



A collection of modern 3 bedroom homes

Everything in easy reach

A collection of stylish 3 bedroom homes available with shared ownership at the exciting new Maddoxford Park development in Boorley Green, Southampton.

These contemporary homes each come complete with a modern fitted kitchen with built-in oven, hob and extractor, an open plan kitchen/dining area and spacious living room. Also benefiting from a stylish bathroom suite, private garden laid to lawn and two allocated parking spaces.



-  **The Hatch**
-  **The Rookesbury**
-  **Parking spaces**

 **Maddoxford Park,**
Wheatear Road,
Botley,
Southampton,
SO32 2TX

North





The Hatch

3 bedroom end terraced
Plot 10,13*

3  1  2 

Room

Kitchen/dining room	4.9m x 2.9m
Living room	4.9m x 3.8m
Master bedroom	3.7m x 2.6m
Bedroom 2	4.3m x 2.6m
Bedroom 3	3.3m x 2.2m

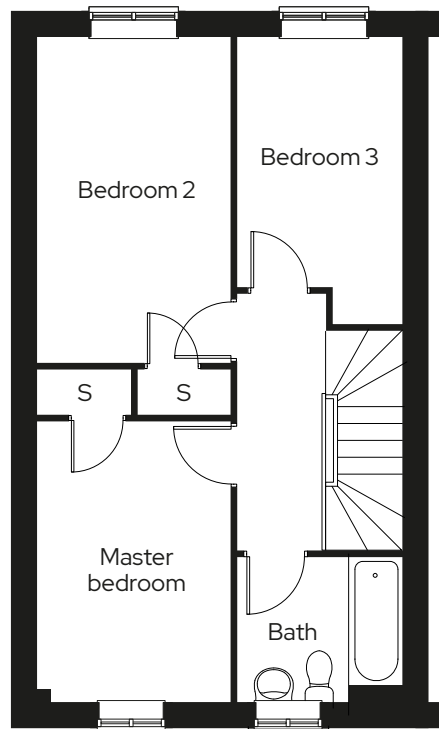
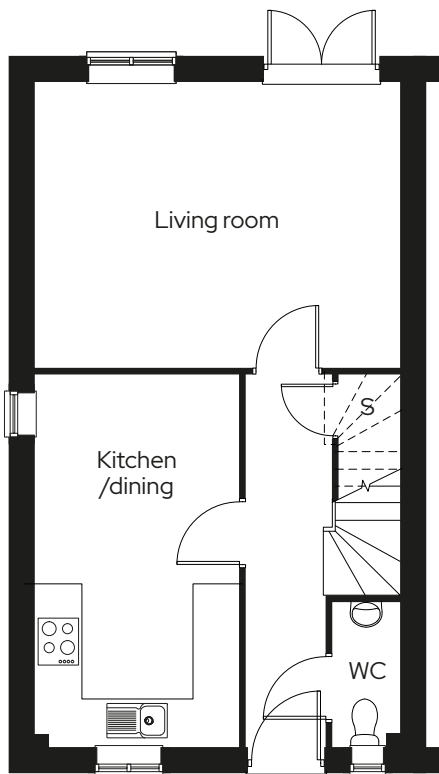

* Mirrored plot S Storage

We operate a policy of continuous product development and individual features such as windows and elevational treatments may vary. Consequently, particulars contained within this document should be treated as general guidance only. They do not constitute a contract, part of a contract or a warranty. Computer generated images and photographs are for illustration purposes only and may not accurately depict individual plots. Dimensions provided are for general guidance and are not intended to be used for carpet sizes, appliances, spaces or items of furniture. All dimensions are maximum.

The Rookesbury

3 bedroom mid terraced
Plot 11,* 12

3 1 2

Room

Kitchen/dining room	4.9m x 2.8m
Living room	4.8m x 3.8m
Master bedroom	3.7m x 2.5m
Bedroom 2	4.3m x 2.5m
Bedroom 3	3.3m x 2.2m

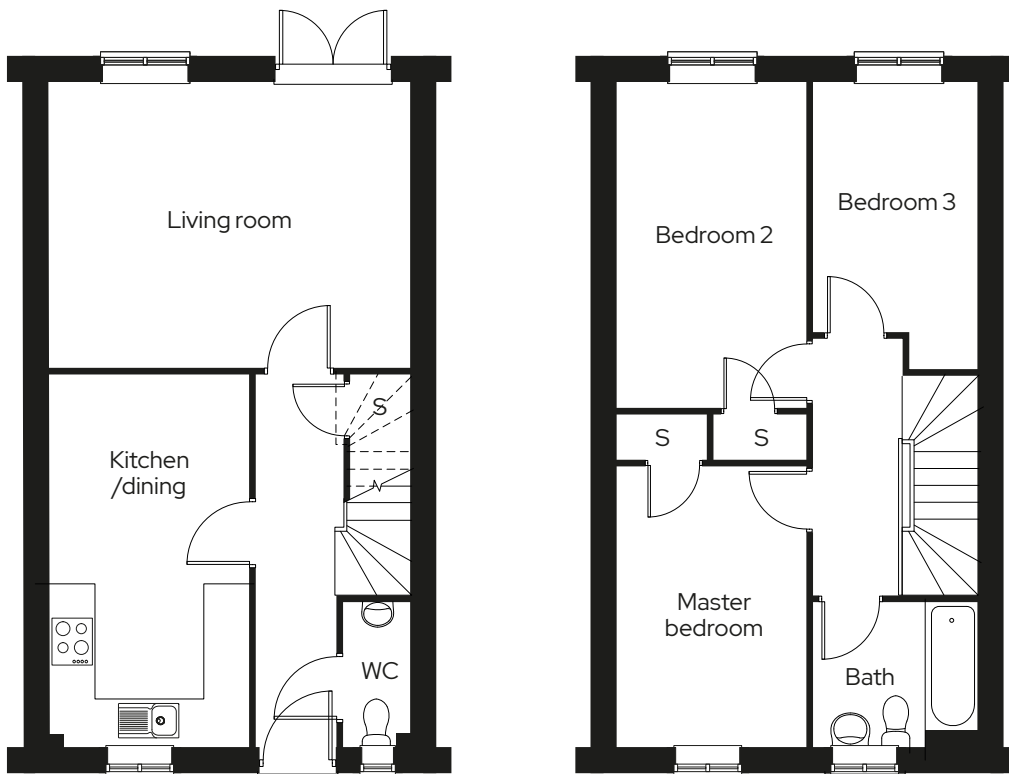

* Mirrored plot S Storage

We operate a policy of continuous product development and individual features such as windows and elevational treatments may vary. Consequently, particulars contained within this document should be treated as general guidance only. They do not constitute a contract, part of a contract or a warranty. Computer generated images and photographs are for illustration purposes only and may not accurately depict individual plots. Dimensions provided are for general guidance and are not intended to be used for carpet sizes, appliances, spaces or items of furniture. All dimensions are maximum.

Get in touch

0300 330 0718

To find out more about shared ownership and the homes we offer, get in touch today.

→ sovereignliving.org.uk

Head office

Sovereign House
Basing View
Basingstoke
RG21 4FA

As one of the UK's leading shared ownership providers, Sovereign is passionate about giving everyone the opportunity to own their own home.

Our highly dedicated sales team has already helped thousands of people step onto the property ladder and our profit with a purpose principle means we can continue to help thousands more. Established, experienced, and affordable, we are proud to help more people live where they love.