



Great Oldbury



A collection of modern 2 bedroom homes

A location spoilt for choice

A collection of modern 2 bedroom homes are coming soon to the Great Oldbury development, located in the picturesque location of Stonehouse, Gloucestershire.

Each home comes complete with a modern fitted kitchen with a built-in oven, hob and extractor and spacious open-plan living. Also benefitting from two spacious bedrooms, bathroom suite, private garden laid to lawn and two allocated parking spaces.



-  The Highgrove
-  Parking spaces

 **Great Oldbury,**
John Wothers Lane,
Stonehouse,
Gloucestershire,
GL10 3GZ

North





The Highgrove

2 bedroom end terraced
Plot 228*, 231

2 1 2

Room	
Kitchen	2.6m x 2.8m
Living/dining room	4.5m x 4.4m
Master bedroom	4.5m x 3.5m
Bedroom 2	2.4m x 4.8m

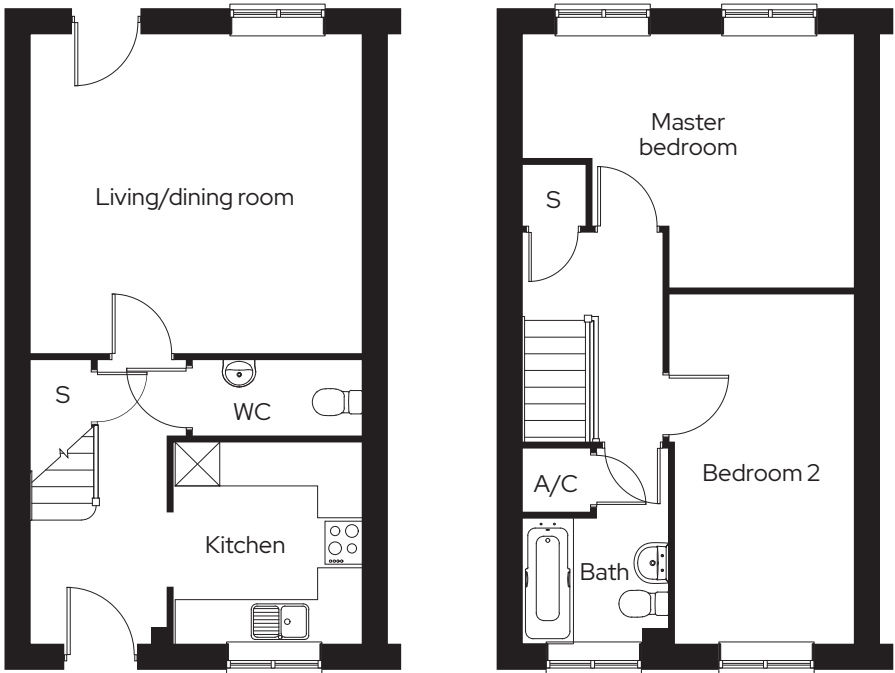

* Mirrored plot A/C Airing cupboard S Storage

We operate a policy of continuous product development and individual features such as windows and elevational treatments may vary. Consequently, particulars contained within this document should be treated as general guidance only. They do not constitute a contract, part of a contract or a warranty. Computer generated images and photographs are for illustration purposes only and may not accurately depict individual plots. Dimensions provided are for general guidance and are not intended to be used for carpet sizes, appliances, spaces or items of furniture. All dimensions are maximum.

The Highgrove

2 bedroom mid terraced
Plot 229*, 230

2  1  2 

Room

Kitchen	2.6m x 2.8m
Living/dining room	4.5m x 4.4m
Master bedroom	4.5m x 3.5m
Bedroom 2	2.4m x 4.8m

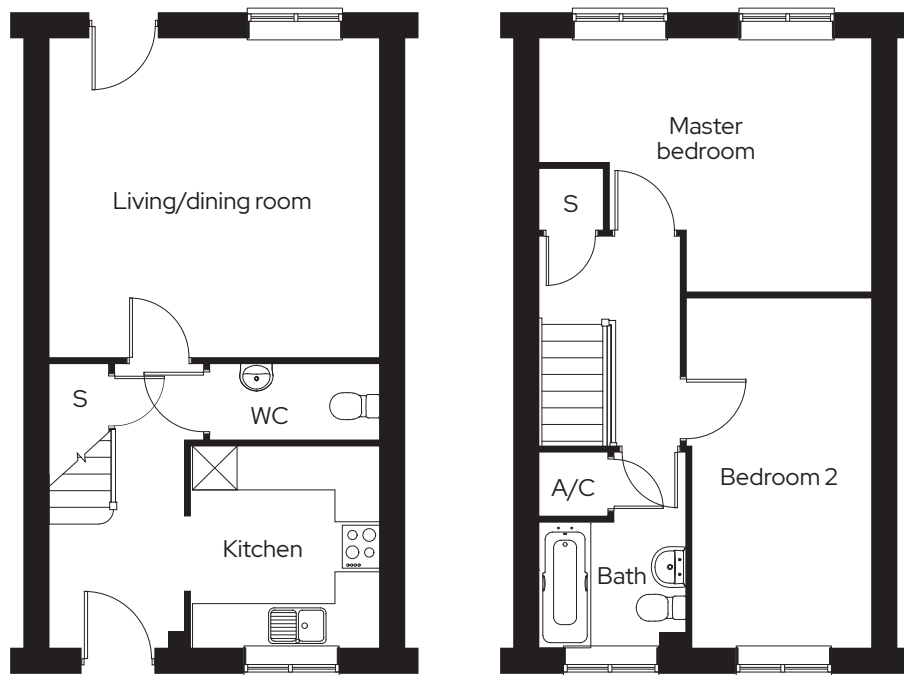

* Mirrored plot A/C Airing cupboard S Storage

We operate a policy of continuous product development and individual features such as windows and elevational treatments may vary. Consequently, particulars contained within this document should be treated as general guidance only. They do not constitute a contract, part of a contract or a warranty. Computer generated images and photographs are for illustration purposes only and may not accurately depict individual plots. Dimensions provided are for general guidance and are not intended to be used for carpet sizes, appliances, spaces or items of furniture. All dimensions are maximum.

Get in touch

0300 330 0718

To find out more about shared ownership and the homes we offer, get in touch today.

→ sovereignliving.org.uk

Head office

Sovereign House
Basing View
Basingstoke
RG21 4FA

As one of the UK's leading shared ownership providers, Sovereign is passionate about giving everyone the opportunity to own their own home.

Our highly dedicated sales team has already helped thousands of people step onto the property ladder and our profit with a purpose principle means we can continue to help thousands more. Established, experienced, and affordable, we are proud to help more people live where they love.