

# Potters Grove

## Type A4

2 Bedroom apartment  
Plots 92, 102 & 112

2  1  1 

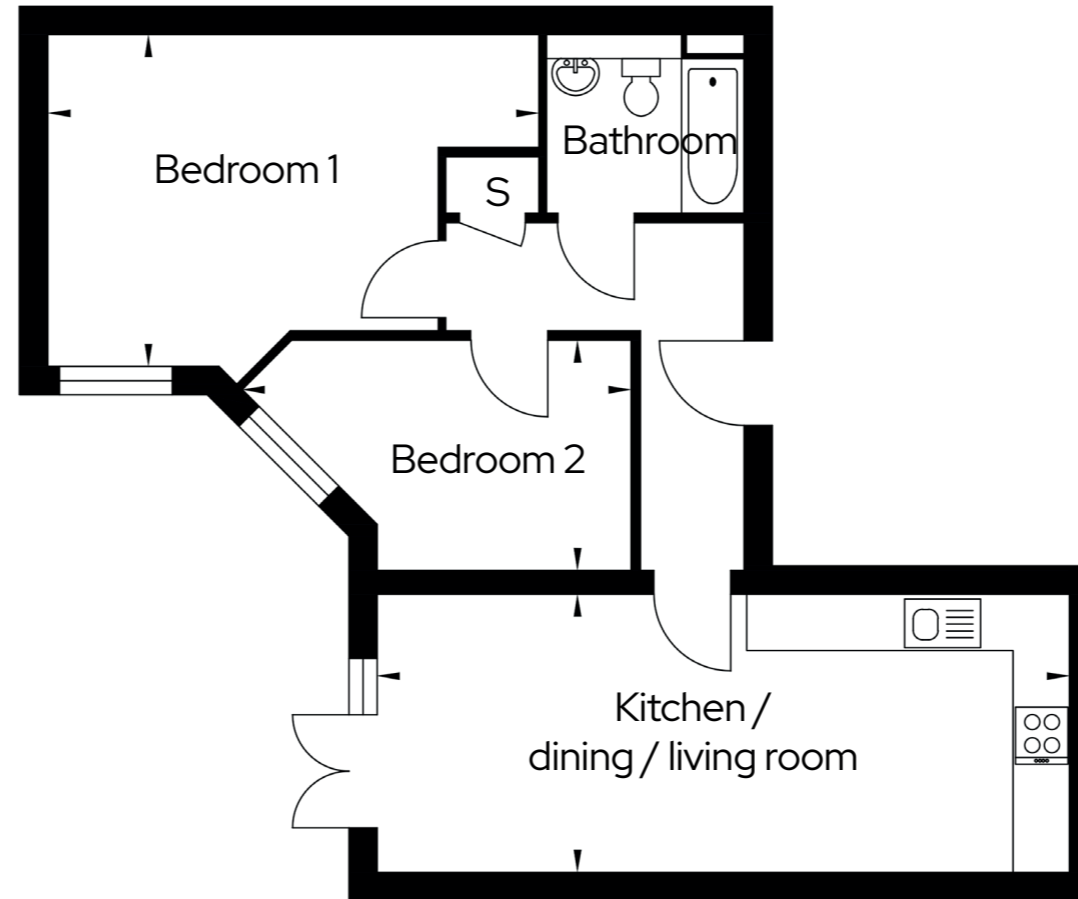

S Storage

Second  
Floor

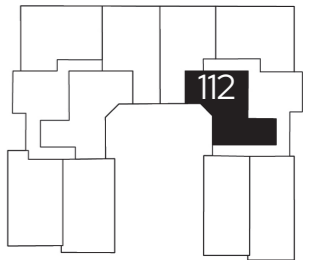

First  
Floor

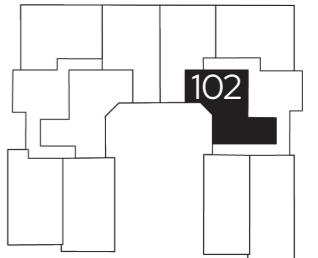

Ground  
Floor

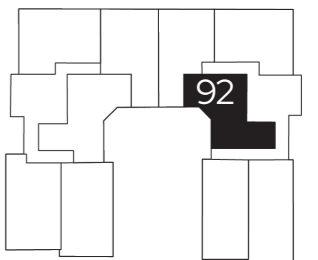

### Room

Kitchen/Dining/Living 7.4m x 3.0m

Bedroom one 4.1m x 2.1m

Bedroom two 2.5m x 2.7m