



Potters Wood

A collection of 2 & 3 bedroom homes

Enjoy beautiful landscapes on your doorstep

Potters Wood offers a selection of 2 & 3 bedroom homes, each benefitting from open plan living, downstairs cloakroom, private garden and allocated parking for 2 cars.

Surrounded by forest and heathland close to the border of the New Forest National Park and just 6 miles from the market town of Ringwood, Verwood is a modern town with a good selection of independent and national retailers, schools, restaurant, cafes and leisure facilities.



- The Hawthorn
- The Hazel
- The Blackthorn
- Parking spaces

 **Potters Wood**
Gamekeeper Way,
Verwood,
BH31 7DL



North
↑





The Hawthorn

3 bed mid & end terraced
Plot 50, 51*

3  1  2 

Room

Kitchen/dining	3.5m x 4.4m
Living room	5.0m x 2.6m
Master bedroom	2.8m x 4.0m
Bedroom 2	2.8m x 4.0m
Bedroom 3	2.1m x 2.5m

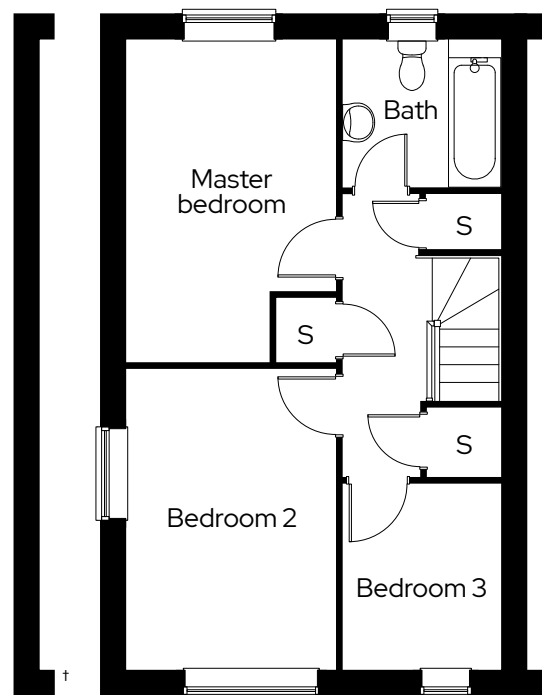
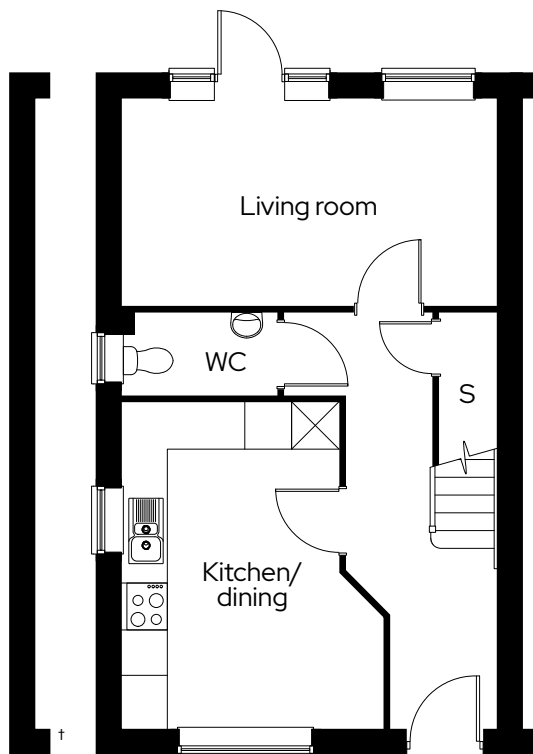



† Side of plot 51 * Mirrored plot S Storage

We operate a policy of continuous product development and individual features such as windows and elevational treatments may vary. Consequently, particulars contained within this document should be treated as general guidance only. They do not constitute a contract, part of a contract or a warranty. Computer generated images and photographs are for illustration purposes only and may not accurately depict individual plots. Dimensions provided are for general guidance and are not intended to be used for carpet sizes, appliances, spaces or items of furniture. All dimensions are maximum.

The Blackthorn

2 bedroom end terraced
Plot 52

2  1  2 

Room

Living/dining	4.6m x 3.7m
Kitchen	2.2m x 3.7m
Master bedroom	4.6m x 2.9m
Bedroom 2	2.5m x 4.4m

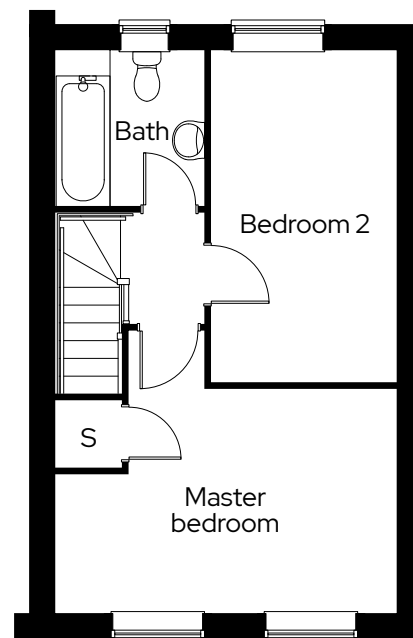
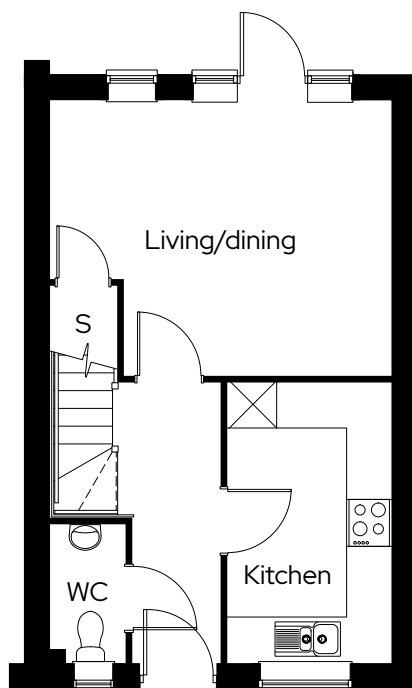



* Mirrored plot S Storage

We operate a policy of continuous product development and individual features such as windows and elevational treatments may vary. Consequently, particulars contained within this document should be treated as general guidance only. They do not constitute a contract, part of a contract or a warranty. Computer generated images and photographs are for illustration purposes only and may not accurately depict individual plots. Dimensions provided are for general guidance and are not intended to be used for carpet sizes, appliances, spaces or items of furniture. All dimensions are maximum.

The Hazel

2 bed mid & end terraced
Plot 57*, 58, 59

2  1  2 

Room

Living/dining	4.6m x 3.7m
Kitchen	2.2m x 3.7m
Master bedroom	4.6m x 2.9m
Bedroom 2	2.5m x 4.4m

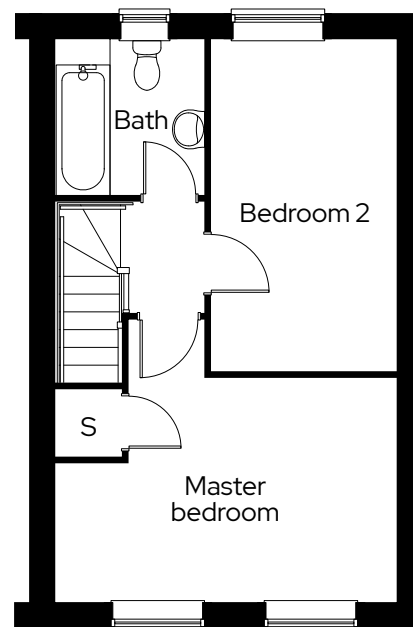
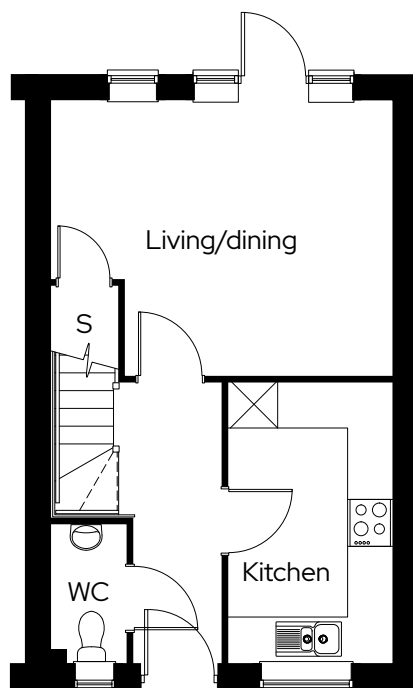

* Mirrored plot S Storage

We operate a policy of continuous product development and individual features such as windows and elevational treatments may vary. Consequently, particulars contained within this document should be treated as general guidance only. They do not constitute a contract, part of a contract or a warranty. Computer generated images and photographs are for illustration purposes only and may not accurately depict individual plots. Dimensions provided are for general guidance and are not intended to be used for carpet sizes, appliances, spaces or items of furniture. All dimensions are maximum.

Get in touch

0300 330 0718

To find out more about shared ownership and the homes we offer, get in touch today.

→ sovereignliving.org.uk

Head office

Sovereign House
Basing View
Basingstoke
RG21 4FA

As one of the UK's leading shared ownership providers, Sovereign is passionate about giving everyone the opportunity to own their own home.

Our highly dedicated sales team has already helped thousands of people step onto the property ladder and our profit with a purpose principle means we can continue to help thousands more. Established, experienced, and affordable, we are proud to help more people live where they love.