



# JI ONDUROOF PIR

MR091 / 01 FEB 2024



Joris Ide NV is not responsible for printing errors and / or any differences between the images in this catalogue and the final product delivered. Joris Ide NV reserves the right to modify the technical specifications at any time without prior notice. To ensure that you have the latest version at hand, we invite you to scan this QR code to retrieve the latest version on our website [www.joriside.com](http://www.joriside.com).



## Index

Description	2
Weight and thermal performance	2
Maximum recommended span length	2
Materials	3
Confidex® Guarantee by Tata Steel	4
Performance	5
Dimensions and tolerances	7
Certifications, quality and durability	8
JI Onduroof PIR - Roof application, Step 1	10
JI Onduroof PIR - Roof application, Step 2	12
JI Onduroof PIR - Vertical Wall application, Step 1	14
JI Onduroof PIR - Vertical Wall application, Step 2	16
Accessories	18
Fasteners	18
Sealants	18
Flashings and others	19

# JI ONDUROOF PIR

## Insulated panels (PIR core)

The JI Onduroof PIR is a very diverse user product for not only Industrial, but also Residential or Agricultural Application.

Due to its corrugated outer sheet it is ideal to take additional loads such as solar panels or even roof tiles.



JI Onduroof PIR during built up.



The JI Onduroof PIR for seen from below.

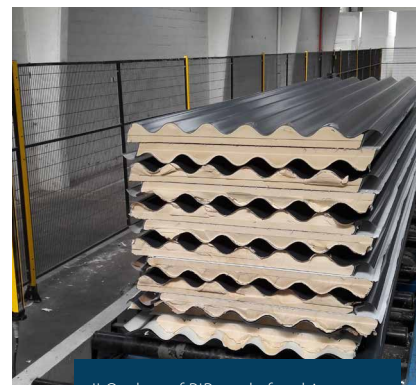

JI Onduroof PIR ready for shipment.

The Joris Ide group, with more than 3 decades of experience, processing 419.000 tonnes of steel per year and have 16 production sites in over 8 countries. With the help of more than 1230 employees Joris Ide is your dedicated partner.



## Description

The JI Onduroof PIR Insulated Panel is used for pitched roofs, horizontal and vertical wall applications and as external insulated cladding panel for industrial, commercial and public buildings. The minimum pitch to be applied is 4° or more after deflection.

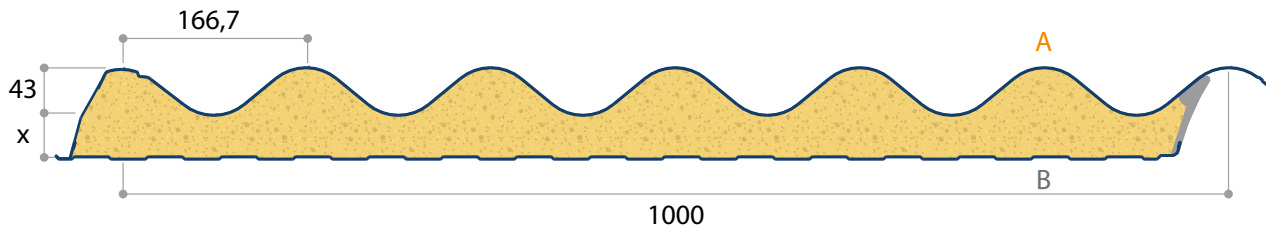

## Weight and thermal performance

Article	Thickness (mm)	Weight (kg/m <sup>2</sup> )	U [W/m <sup>2</sup> .K]	R [m.K/W]	Rw [dB]
2666	40	11,11	0,36	2,56	24(-2;-4)
2893	60	11,86	0,29	3,45	25(-2;-4)
4273	80	12,62	0,23	4,40	26(-3;-5)
6950	120	14,13	0,16	6,30	27(-3;-5)

U is obtained by adding the occasional thermal bridges due to the fasteners ( $U = U_c + (\psi/1) + (\chi * \#screw/m^2)$ )

## Maximum recommended span length

	40	60	80	120
Single span	2,73	3,18	3,65	4,31
Double span	3,10	3,47	3,74	4,31
Multiple span	3,10	3,47	3,74	4,31

Values for pressure load case of 2.00kN/m<sup>2</sup>.

## System key benefits

- Applicable as roof and wall panel for renovations and new buildings.
- Easy handling, mounting and fitting.
- Composite panel allows a faster installation time than standard built-up systems.
- JI Onduroof PIR is produced according to the EN ISO 9001:2015.
- The JI Onduroof PIR is CE-marked.
- Wide range of colours and coatings available for top sheet according to your project (please consult our Colorflow).
- Inner sheets with different colours available on request
- Production facility ISO 14001:2015 certified.
- Environmental sustainable PIR foam with zero ozone depletion and a low global warming potential.
- Inner sheet comes as standard in 15 µ Polyester with a RAL 9002 colour.
- JI Onduroof PIR is available in lengths up to 16 m. The minimum cut back is 50 mm.
- Matching single skin profiles in metal or GRP (max length 8m50) are available.
- Factory applied weather seals to the side lap (FAWS)
- FM approved



## Materials

### A1. External weather sheet

Joris Ide offers one of the widest ranges in coatings and colours which can be defined per project and building requirements. Please consult our colorflow brochure for detailed information.



#### Essential 25 $\mu$

5 microns primer + 20 microns top coat

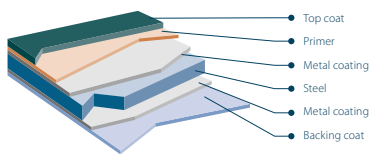

#### HPS 200 Ultra® 200 $\mu$

200 microns + Scintilla® embossing

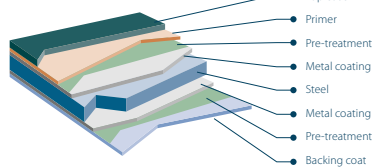

#### Ultra 75

70 - 75 $\mu$  (primer + top coat)

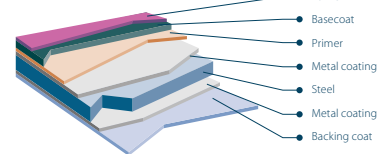

#### Ultra 60

25 microns primer + 30 microns top coat

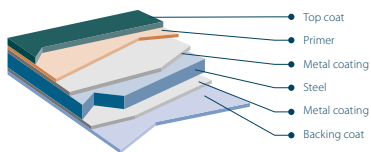

### A2. Internal liner sheet

Internal conditions of a building can vary; Joris Ide can offer a wide range to suit heavy-duty environments such as humidity and ammoniac. Please consult our colorflow brochure for detailed information.

- 15  $\mu$  Polyester RAL 9002 (standard)
- 25  $\mu$  Polyester
- Colorfarm 35 $\mu$
- PVC Foodsafe 150  $\mu$  PVC
- HPS 200  $\mu$
- Ultra 60
- Ultra 75

### A3. Insulation core

Jl Onduroof PIR insulated panels are made with a high thermal performance and environmental sustainable PIR foam with zero ozone depletion and a low global warming potential.

## Confidex® Guarantee by Tata Steel

For over 20 years the Confidex® Guarantee from Tata Steel has remained best in class. Confidex® is the product performance guarantee for Colorcoat HPS200 Ultra®, when used in an external conventional building envelope application namely roof and wall cladding using single skin, built-up or composite panel construction in industrial and commercial buildings. Confidex® offers the longest and most comprehensive guarantee for pre-finished steel in Europe.

### Key features include;

- Extended guarantee cover for up to 40 years on Colorcoat HPS200 Ultra®.
- No requirement for annual inspections or maintenance to validate the guarantee.
- Covers cut edges produced under factory controlled conditions for the entire guarantee period.
- Backed by years of worldwide product testing and real world experience.
- Provides cover for roof pitches down to 1° and no distinction between different roof pitches above that.
- Offered directly to the building owner and provides a contractual relationship between Tata Steel and the building owner.
- Fully transferable should building ownership change.
- Helps reduce the level of risk for each part of the supply chain.
- Quick and simple online registration form.

### Other warranties

With Confidex® registration



Without Confidex® registration



Whilst Confidex® has always been restricted to the weathering performance of the external cladding, Tata Steel has recognised the growing emergence of demanding internal environment projects, such as energy from waste plants, and may offer a non-Confidex® warranty on a case by case basis for Colorcoat HPS200 Ultra® used internally.

Application specific warranties are also available for non-standard cladding applications; i.e residential roofs, flashings and sectional roller shutter doors.



Please have a look at our customer portal at [www.joriside.com](http://www.joriside.com) for more information about the guarantee.

### Regions covered by the Confidex® Guarantee



#### KEY

- Northern Europe – Zone 1
- Southern Europe – Zone 2
- For areas outside of Confidex® zones please contact Tata Steel for more information.

### Notes

- Figures under the Coastal heading are for buildings within 1 km of any coast.
- Full terms and conditions of the Confidex® Guarantee are on the online application form, available from [www.colorcoat-online.com/registration](http://www.colorcoat-online.com/registration).
- Confidex® must be registered within 3 months of the building completion date for the guarantee to be valid.
- The Confidex® Guarantee periods on the diagram above are applicable to Zone 1 and Zone 2. For more information visit [www.colorcoat-online.com/confidexmap](http://www.colorcoat-online.com/confidexmap).

*Colorcoat HPS200 Ultra and Confidex are trademarks of Tata Steel UK Limited.*

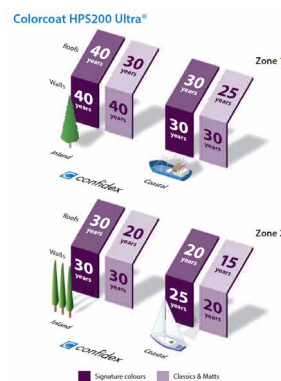

## Performance

## Environmental

The JI Onduroof PIR corresponds to the BRE Global Green Guide online generic specification Galvanised steel rafters and joists, composite profiled roof cladding (steel inner lining, pentane blown PIR insulation, coated steel outer skin) (ref. 812550001) which achieves a summary rating of A+ within pitched roofs. The production facility is ISO 14001:2015 certified.

## Fire

The JI Onduroof PIR is classified B - s2,d0 when tested to BS EN 13501-1:2013.

### End cutback

The panels are supplied as standard with a longitudinal overlap located to the right of the element when standing on the cover looking at the ridge, and a cutback transverse overlap D of 100 mm. It is possible to order panels on the left. It is possible to order the panels with a different cutback covering (min. 50 mm - max. 300 mm). In this case, it is necessary to specify the length L of the sheet and the cutback D.

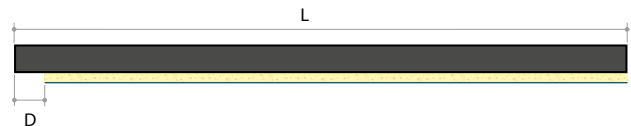

### Fixations

JI Onduroof PIR fixings are made at the tops of ribs with the use of saddle washers.

## Points of attention when installing JI Onduroof PIR

**Step 1:** Firmly press Panel 2 at the marked wave. Panel 2 moves down and to the left.

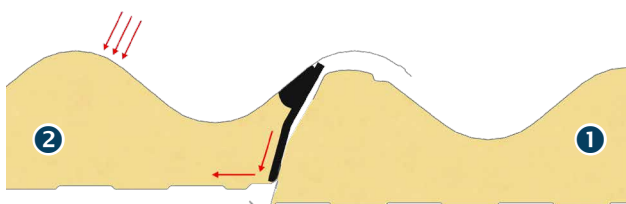

1. Panel 1  
2. Panel 2

**Step 2:** The undersides of Panels 1 and 2 are now aligned. Panel 2 can be screwed in place.

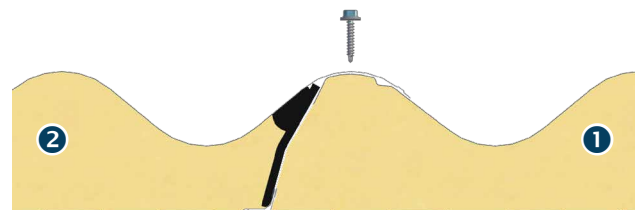

1. Panel 1  
2. Panel 2

## JI Onduroof PIR a cover system

JI Onduroof PIR is offered with a set of complements and connections for making the covers, contact us.

## Performance

Assumptions:

- The span/load table is valid for roof application. Panel self-weight has been taken into account. For intermediate values, liner interpolation may be used.
- Values have been calculated using the method described in BS EN 14509:2013 for light and medium coloured panels (Colour group I-II).
- Deflection limit for short term loads: L/200.
- The minimum required width for end and intermediate supports is 50 mm.
- Calculation of fasteners have not been included.
- In the case of double or triple span conditions, this span/load table can only be used when all spans are equal or when the difference between the spans is less than 10%.
- The span/load table gives the capacity of the panel to carry short term loads. Any creep effect due to snow accumulation or other long-term loads have not been taken into account.

## Spantables

### Operating spans (in meters)

Sizing method used according to Appendix E of standard BS EN 14509:2013 to this document. Admissible spans according to the number of supports and the (unweighted) loads calculated according to the Eurocodes. The deflection criterion considered is L/200th for short term loads. The table applies to buildings with a normal indoor climate (e.g. no cold rooms or freezers). The influence due to the long-term snow load has not been taken into account. If you have any questions, please contact Technical Support.

## Spantable Load type (kN/m<sup>2</sup>)

Color group 1-2 (light and medium colors)

Thickness (mm)			Span (m)																			
			1,30	1,40	1,50	1,60	1,70	1,80	1,90	2,00	2,10	2,20	2,30	2,40	2,50	2,60	2,70	2,80	2,90	3,00	3,10	3,20
40	Pressure	Single	7,84	7,01	6,32	5,74	5,24	4,81	4,43	4,02	3,61	3,26	2,96	2,69	2,45	2,24	2,05	1,89	1,71	1,55	1,40	1,27
		Double	5,77	5,35	4,99	4,67	4,39	4,14	3,91	3,71	3,53	3,37	3,22	3,08	2,88	2,71	2,54	2,39	2,26	2,13	2,01	1,91
		Multiple	5,77	5,35	4,99	4,67	4,39	4,14	3,91	3,71	3,53	3,37	3,22	3,08	2,88	2,71	2,54	2,39	2,26	2,13	2,01	1,91
	Suction	Single	-8,69	-7,78	-7,03	-6,40	-5,86	-5,27	-4,71	-4,24	-3,83	-3,48	-3,17	-2,90	-2,67	-2,46	-2,27	-2,10	-1,95	-1,82	-1,69	-1,56
		Double	-6,94	-6,06	-5,35	-4,76	-4,27	-3,86	-3,51	-3,21	-2,95	-2,72	-2,52	-2,35	-2,19	-2,06	-1,93	-1,82	-1,72	-1,63	-1,54	-1,47
		Multiple	-8,28	-7,23	-6,38	-5,68	-5,11	-4,62	-4,21	-3,86	-3,55	-3,29	-3,05	-2,85	-2,66	-2,50	-2,35	-2,22	-2,10	-1,99	-1,89	-1,80
60	Pressure	Single	8,30	7,52	6,86	6,29	5,80	5,38	5,00	4,66	4,35	4,07	3,82	3,59	3,35	3,09	2,85	2,64	2,45	2,27	2,11	1,97
		Double	7,72	7,16	6,68	6,26	5,80	5,38	5,00	4,66	4,35	4,07	3,82	3,59	3,38	3,19	3,01	2,85	2,69	2,55	2,42	2,30
		Multiple	7,72	7,16	6,68	6,26	5,80	5,38	5,00	4,66	4,35	4,07	3,82	3,59	3,38	3,19	3,01	2,85	2,69	2,55	2,42	2,30
	Suction	Single	-10,38	-9,42	-8,62	-7,93	-7,33	-6,69	-6,03	-5,48	-4,99	-4,57	-4,20	-3,87	-3,58	-3,32	-3,08	-2,87	-2,68	-2,50	-2,35	-2,20
		Double	-6,63	-5,81	-5,15	-4,61	-4,15	-3,76	-3,44	-3,15	-2,91	-2,69	-2,50	-2,34	-2,19	-2,05	-1,93	-1,83	-1,73	-1,64	-1,56	-1,48
		Multiple	-7,77	-6,81	-6,04	-5,40	-4,87	-4,43	-4,05	-3,72	-3,44	-3,20	-2,98	-2,79	-2,62	-2,46	-2,33	-2,20	-2,09	-1,99	-1,89	-1,80
80	Pressure	Single	8,56	7,83	7,20	6,66	6,19	5,77	5,39	5,06	4,75	4,47	4,21	3,97	3,75	3,55	3,36	3,18	3,02	2,87	2,73	2,59
		Double	8,56	7,83	7,20	6,66	6,19	5,77	5,39	5,06	4,75	4,47	4,21	3,97	3,75	3,55	3,36	3,18	3,02	2,87	2,73	2,59
		Multiple	8,56	7,83	7,20	6,66	6,19	5,77	5,39	5,06	4,75	4,47	4,21	3,97	3,75	3,55	3,36	3,18	3,02	2,87	2,73	2,59
	Suction	Single	-12,26	-11,24	-10,37	-9,62	-8,96	-8,24	-7,49	-6,84	-6,28	-5,78	-5,34	-4,95	-4,60	-4,22	-3,89	-3,60	-3,34	-3,10	-2,90	-2,71
		Double	-6,19	-5,45	-4,85	-4,35	-3,93	-3,57	-3,27	-3,00	-2,78	-2,57	-2,40	-2,24	-2,10	-1,98	-1,86	-1,76	-1,67	-1,59	-1,51	-1,44
		Multiple	-7,15	-6,29	-5,60	-5,03	-4,55	-4,14	-3,80	-3,51	-3,25	-3,02	-2,83	-2,65	-2,49	-2,35	-2,23	-2,11	-2,01	-1,91	-1,82	-1,74
120	Pressure	Single	9,42	8,74	8,14	7,62	7,15	6,73	6,34	5,99	5,66	5,36	5,08	4,82	4,58	4,35	4,14	3,94	3,75	3,57	3,41	3,25
		Double	9,42	8,74	8,14	7,62	7,15	6,73	6,34	5,99	5,66	5,36	5,08	4,82	4,58	4,35	4,14	3,94	3,75	3,57	3,41	3,25
		Multiple	9,42	8,74	8,14	7,62	7,15	6,73	6,34	5,99	5,66	5,36	5,08	4,82	4,58	4,35	4,14	3,94	3,75	3,57	3,41	3,25
	Suction	Single	-15,78	-14,68	-13,72	-12,87	-12,12	-11,07	-10,16	-9,36	-8,66	-8,04	-7,29	-6,65	-6,09	-5,60	-5,17	-4,79	-4,45	-4,14	-3,87	-3,62
		Double	-5,91	-5,24	-4,68	-4,22	-3,83	-3,49	-3,21	-2,96	-2,74	-2,54	-2,37	-2,22	-2,09	-1,97	-1,86	-1,76	-1,67	-1,59	-1,51	-1,44
		Multiple	-6,68	-5,90	-5,27	-4,75	-4,32	-3,95	-3,63	-3,36	-3,12	-2,92	-2,73	-2,57	-2,42	-2,29	-2,18	-2,07	-1,97	-1,88	-1,80	-1,72

The minimum required width for end and intermediate supports is 50 mm.  
Deflection limit for short term loads: L/200.  
Calculation of fasteners have not been included.

Steel grade: S280GD, external sheet 0,60 mm, internal sheet 0,40 mm.



## Dimensions and tolerances

Minimum cutback : 50 mm – maximum cutback : 300 mm (no cutback: not possible) Cutback 25 mm for wall application (on demand) Panels can be manufactured for placing left to right and right to left as per your requirements.

## Special specifications

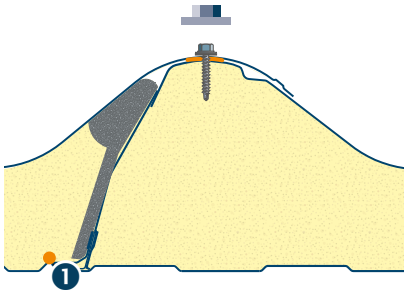

1. sealing kit

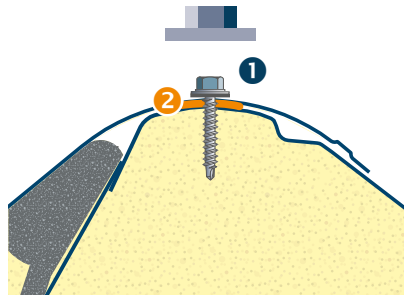

1. overlap screw  
2. butyl band

## Minimum insulation length of panels

40 mm	2250
60 mm	2250
80 mm	2250
120 mm	2250

## Cut-back system

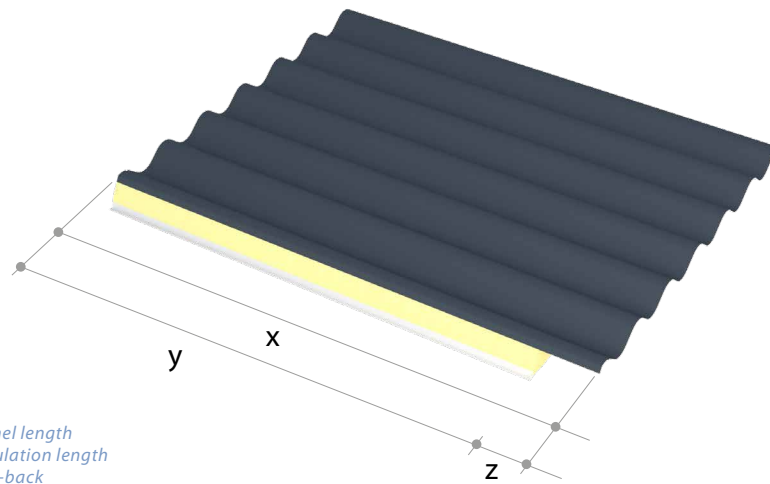

x. Panel length  
y. Insulation length  
z. Cut-back

## Product tolerance

Length < 3000 mm	± 5 mm
Length > 3000 mm	± 10 mm
Width	± 2 mm
Gauge	± 2 mm

Product tolerances [ According to EN 14509:2013]

## Certifications, quality and durability

The JI Onduroof PIR is manufactured according to the ISO 9001 and is assembled from high-quality raw materials which are selected by a detailed supply chain management and in-house laboratory controls. The Joris Ide plant in Zwevezele is ISO 14001:2015 certified. The product is produced to the highest quality standards such as EN 14509. The JI Onduroof PIR carries the product conformity according to the European legislation and therefore all packs are CE-marked and carry the Declaration of Performance.



Assessed to  
ISO 9001:2015



Assessed to  
ISO 14001:2015

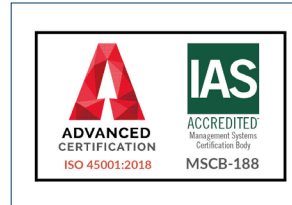

Assessed to  
ISO 45001:2018



Assessed to  
BES 6001

### Optional



Assessed to  
ISO 37301:2021

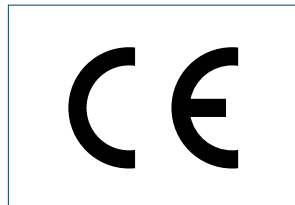

## Accessories

Joris Ide can supply accessories such as foam fillers, flashings, matching outer single skin sheets and GRP roof lights.

## Maintenance composite panels

Joris Ide advises to do an annual inspection of the panels and to carry out any remedial work identified during inspection.

The maintenance & cleaning frequency is dependant on the application environment and actual pollution conditions of the composite panel. Exterior used panels need to be cleaned once per year. For interior used panels, the cleaning is dependant on the actual pollution conditions.

The cleaning of building walls should be made from up to down manually or by suitable cleaning facilities. Please notice that any cleaner which includes corrosive material is forbidden to be used for the cleaning. Specific cleaning processes as follow:

- Use plenty of clean water to wash the panel's surface;
- Use soft cloth with diluted detergent to wipe the panel's surface softly;
- Use clean water again to wash the stains off;
- Check the panel's surface and special cleaning with detergent is needed, if some parts are still not clean;
- Use clear water to wash the panels' surface till all stains have been washed out.

### Notice:

Please don't clean if the panel's surface is hot (over 40 °C) because too fast volatility of the water will do harm to the coating. Please notice especially that suitable detergent should be chosen. Generally neutral detergent is OK. Please don't use strong alkaline detergent, such as potassium hydroxide, sodium hydroxide and also please don't use strong acid detergent, abrasive detergent and paint soluble detergent. We would suggest to clean a small part as an experiment before carrying out thorough cleaning of the whole project.

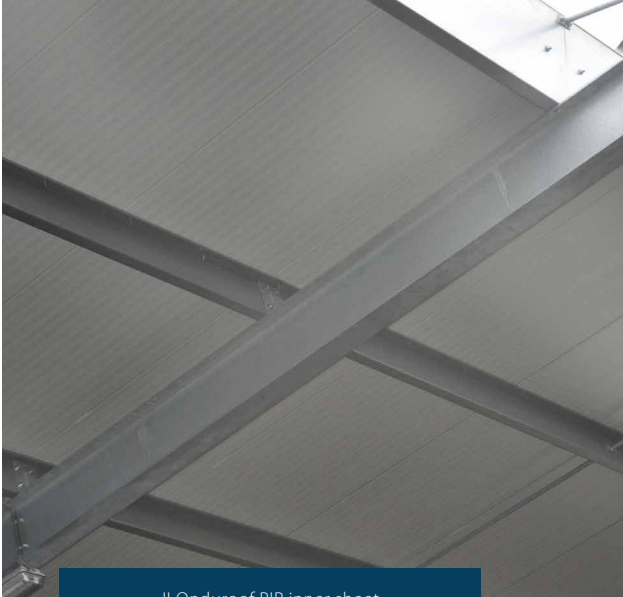

JI Onduroof PIR inner sheet



JI Onduroof PIR used in a residential project.



Installation of the JI Onduroof PIR.

## JI Onduroof PIR - Roof application, Step 1

### JI Onduroof PIR

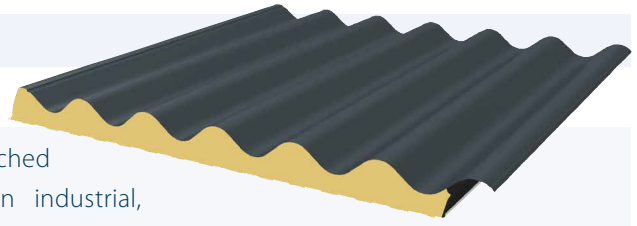

The JI Onduroof PIR Insulated Roof Panel is used for pitched roofs or horizontal and vertical wall applications in industrial, commercial and public buildings. Due to its metal inner and outer sheet, it combines thermal resistance with large spans. The minimum pitch to be applied is 4° or more after deflection.

The panels must be placed from eaves to ridge and from right to left as standard (side lap on the other side can be produced on demand). The panels are to be placed as indicated with ①, ②, ③ and ④.

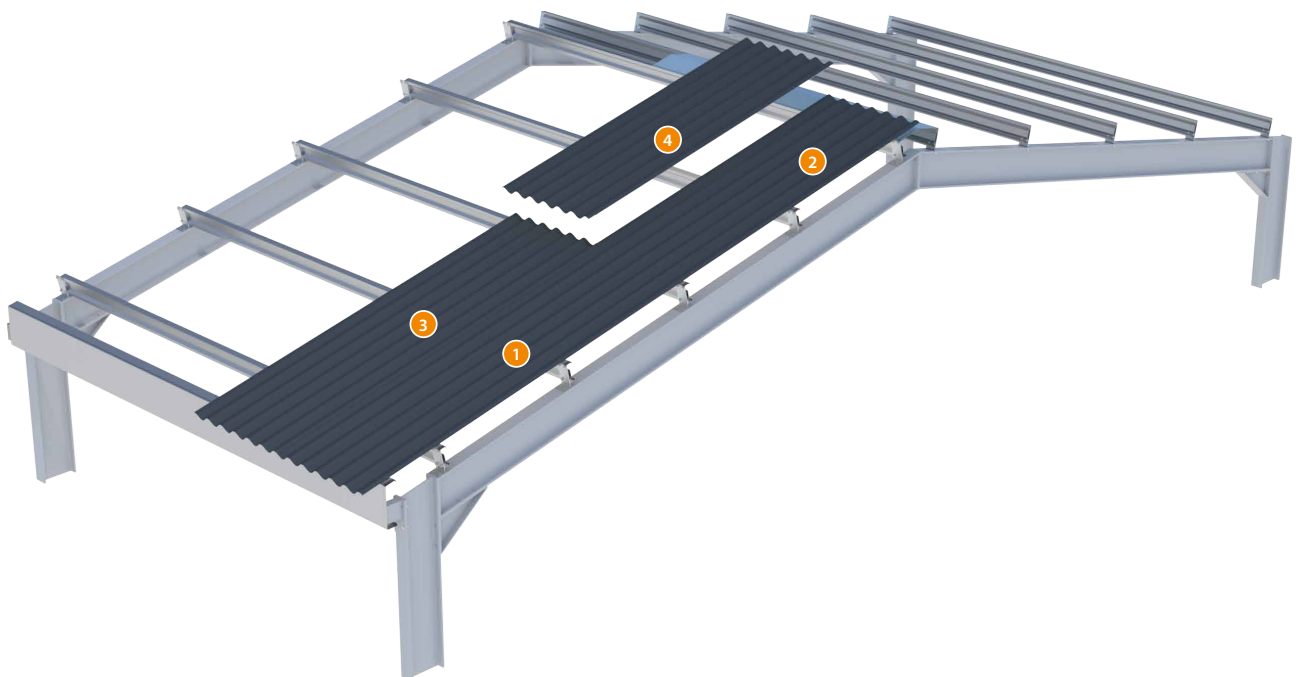

## Eaves detail



A strip of Butyl tape air sealant 6 mm x 5 mm **3** should be applied to the eaves beam to protect the contact with both wall and roof panels.

## End lap

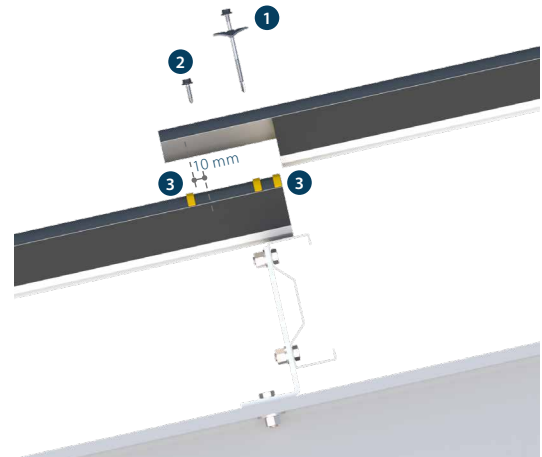

Overlap of JI Onduroof PIR panels with a minimum 150 mm. Main fastener **1** in every other crown. Stitcher screws **2** in each crown at 50 mm from edge. 3 x strips of Butyl tape air sealant 6 mm x 5 mm **3**. Butyl should be placed at 10 mm from edge (max. 20 mm).

## External ridge

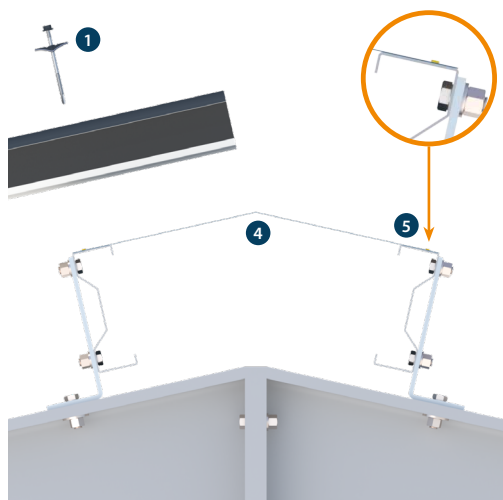

An Internal flashing **4** sealed with a butyl air sealant 9 mm x 3 mm **5** for a proper external ridge. Flashing fixed by panel main fixings **1**.

## Verge detail

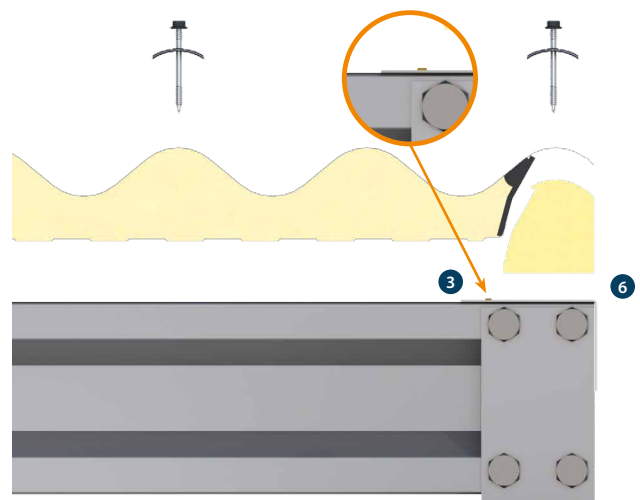

A strip of Butyl tape air sealant 6 mm x 5 mm **3** should be applied between the cleader **6** angle and panels.



## JI Onduroof PIR - Roof application, Step 2

Joris Ide is able to provide the best finishings for your building with a range of products that include sealants, flashings and fixings. Flashings can be ordered with the same coating and colour as the sandwich panels. Stainless steel fixings will provide resistance to the most severe environment. More info on page 14.

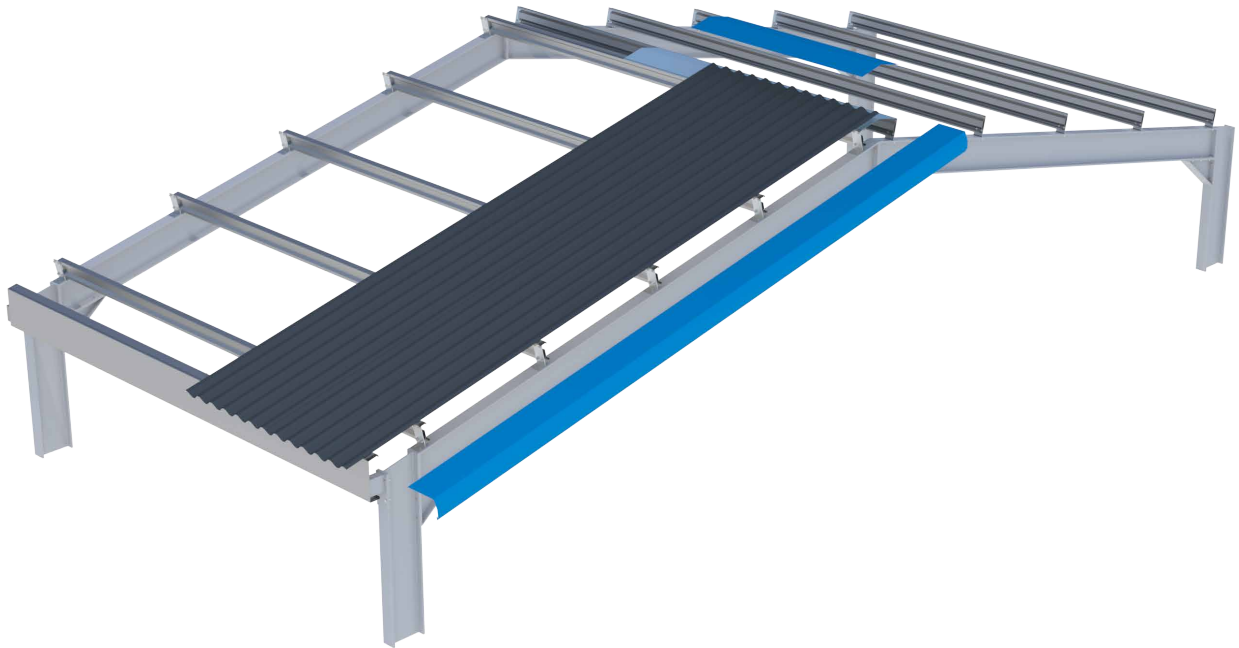

### Side & End lap

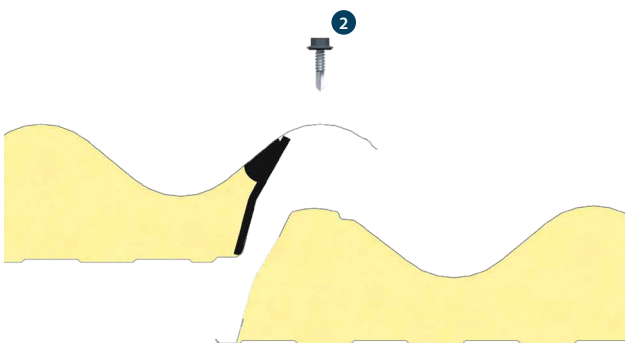

The side lap between panels should be fixed with stitcher screws ② in the crown at max. 450 mm center. The side lap is protected with a compressible factory applied sealant. It is recommended to use additional gun-grade sealant (site-applied) ⑦ on coastal sites.



An additional strip of Butyl tape air sealant 6 mm x 5 mm ③ is recommended where the side lap meets the end lap to reinforce the tightness.

## Finishings

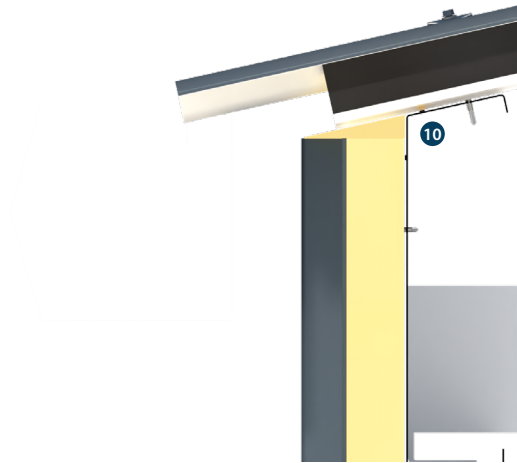

A fire rated site-applied foam insulation 10 must be used to close the corner between wall and roof.

## External ridge - Finishings

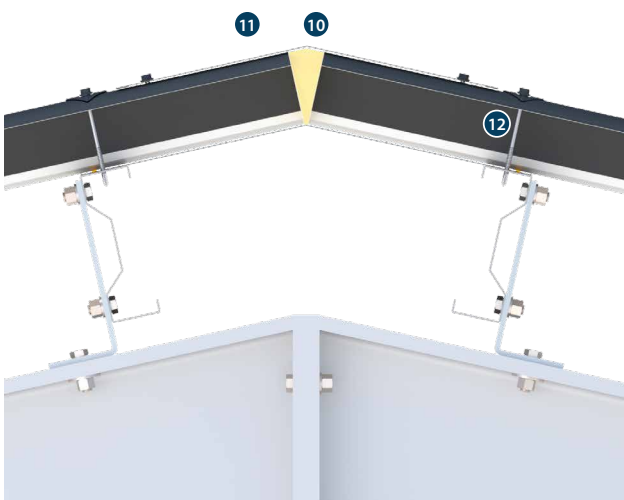

A ridge flashing 11 sealed with a 9 mm x 3 mm butyl air sealant 5 or gun-grade butyl sealant 7 to cover the ridge. A profiled foam filler 12 needs to be used at 80-100 mm from end. A fire rated site-applied foam insulation 10 must be applied to fill the ridge.

## Verge detail - Finishings

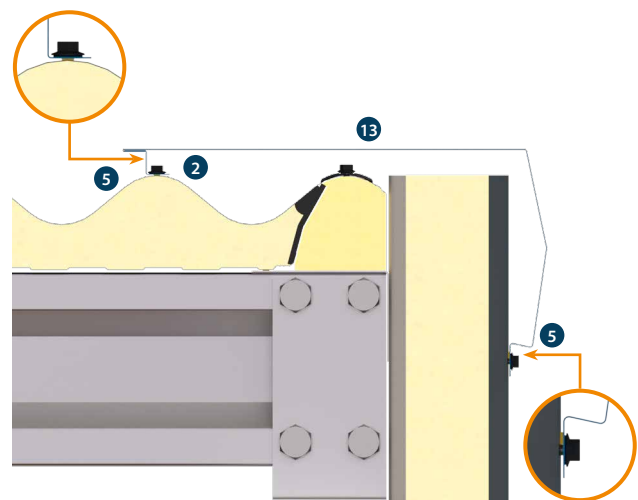

The verge flashing 13 should cover the verge from eaves to ridge and should be fixed with stitching screws at every 450 mm 2 and protected with 9 mm x 3 mm butyl air sealant 5.

## JI Onduroof PIR - Vertical Wall application, Step 1

### JI Onduroof PIR

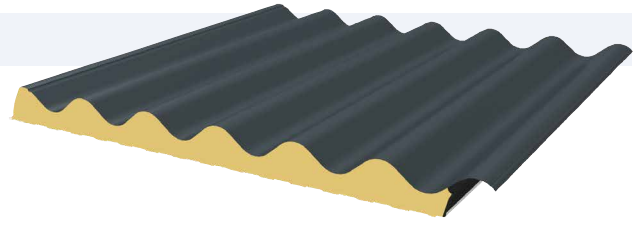

The panels must be placed from bottom to top and from left to right (side laps on the other side can be produced on demand). The panels are to be placed as indicated with ①, ②, ③ and ④.



## Vertical end lap

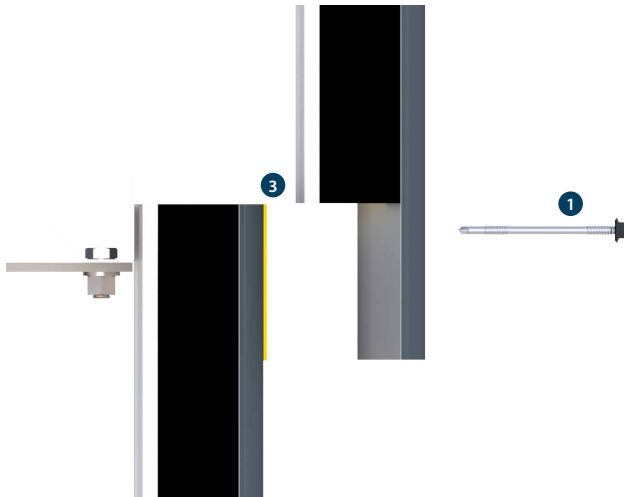

Overlap of JI Onduroof panels with 100 mm. Main fastener **1** in every other valley. 1 x strip of Butyl tape air sealant 6 mm x 5 mm **3** or gun-grade butyl sealant **7**.

## Panels sequence

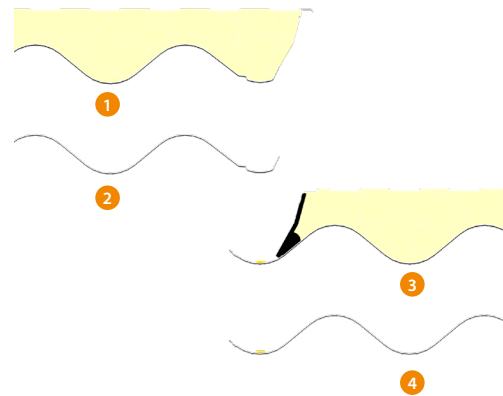

The sequence of panels should be as illustrated with **1**, **2**, **3** and **4**.

## External fill - Insulation

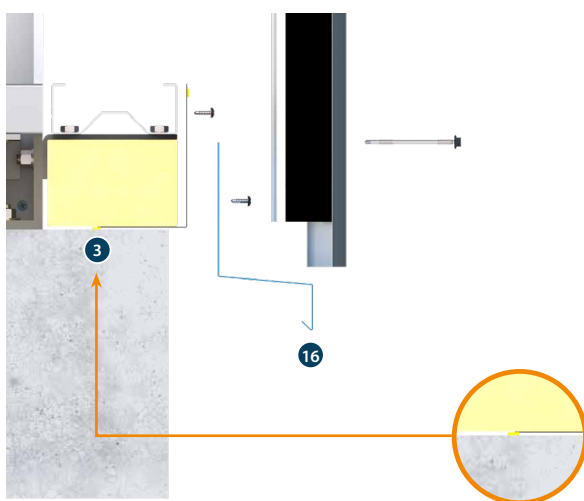

PIR board insulation and site applied fire rated insulation to fill any gaps. An internal closure flashing placed over a strip of butyl tape air sealant 6 mm x 5 mm **3**. The drip flashing **16** is fixed to the internal closure. JI Onduroof to be fixed to first rail through the flashing.

## External fill - sealants

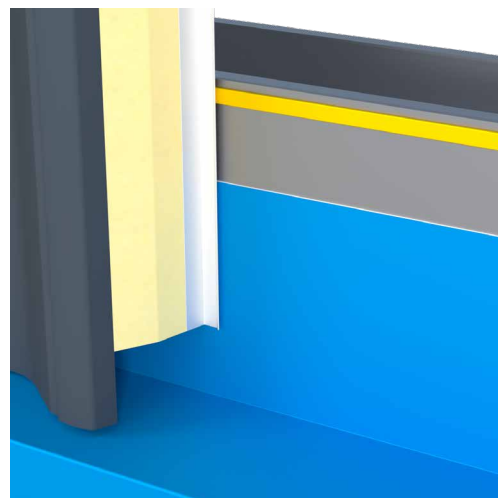

1 x strip of Butyl tape air sealant 6 mm x 5 mm **3** should be applied on supports before placing the panels.

## JI Onduroof PIR - Vertical Wall application, Step 2

Joris Ide is able to provide the best finishings for your building with a range of products that include sealants, flashings and fixings. Flashings can be ordered with the same coating and colour as the sandwich panels. Stainless steel fixings will provide resistance to the most severe environment. More info on page 14.

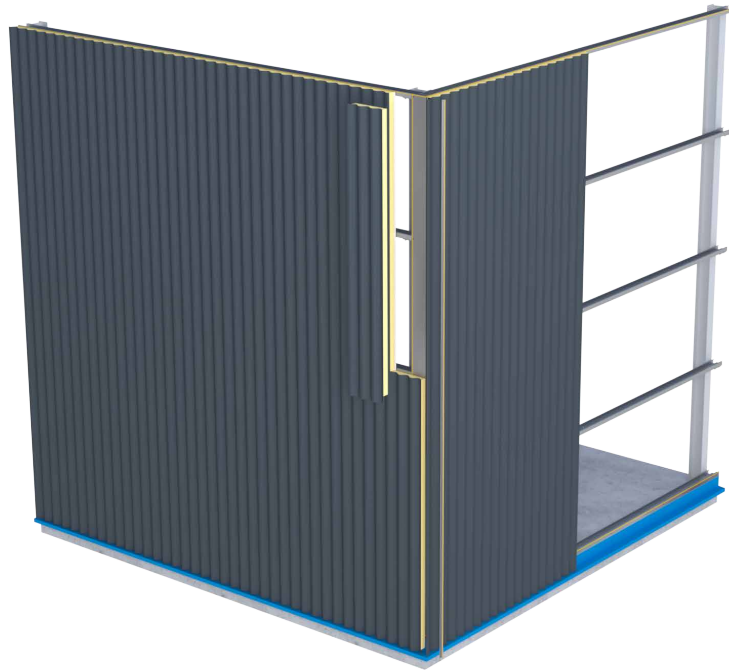

### Side lap

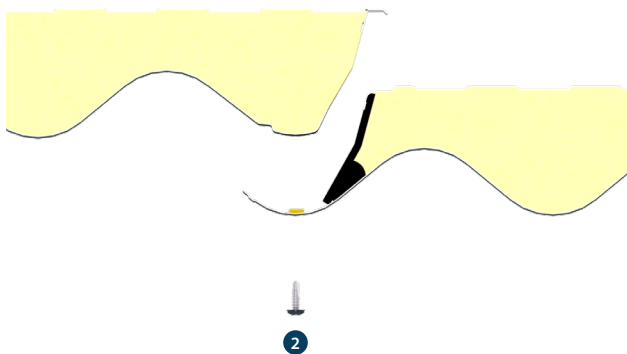

The side lap should be fixed with stitcher screws ② in the crown at max. 450 mm centers.

### External Corner

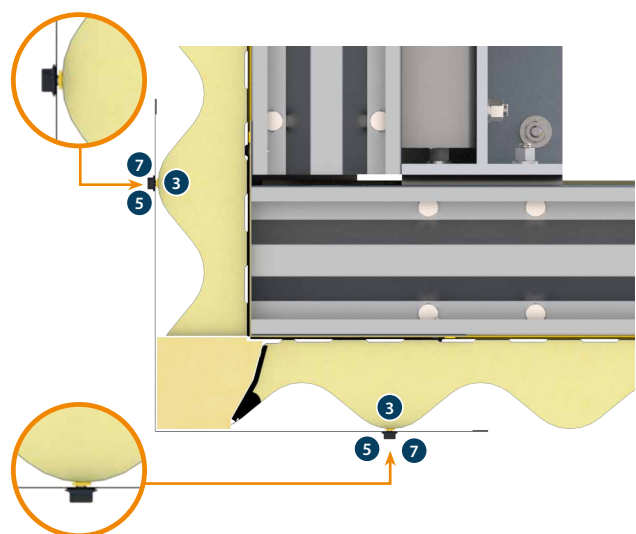

1 x strip of Butyl tape air sealant 6 mm x 5 mm ③ or gun-grade butyl sealant ⑦ between internal cleader ⑥ and panels (each side). 1 x strip of Butyl air sealant 9 mm x 3 mm ⑤ between panel's crown and flashing. PIR fire-rated board insulation at the corner.



## Finishing 1



## Finishing 1 - Detail

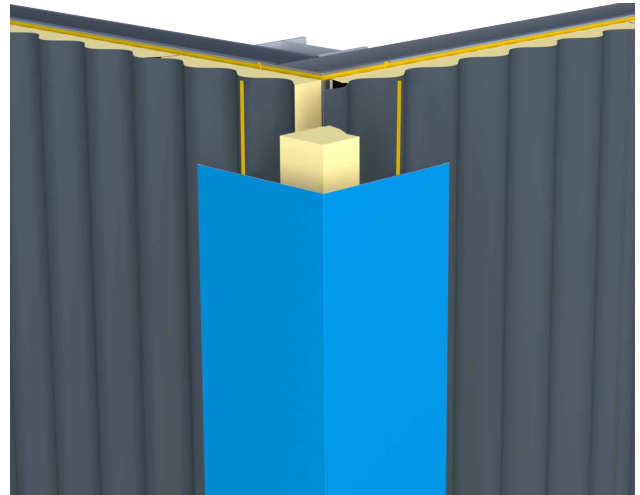

Butyl air sealant should always be used between any surface in contact with JI Onduroof panel. 1 x strip of Butyl air sealant 9 mm x 3 mm **5** is recommended between panel's crown and flashing. PIR fire-rated board insulation should be used at the corners to reduce thermal bridging.

## Finishing 2

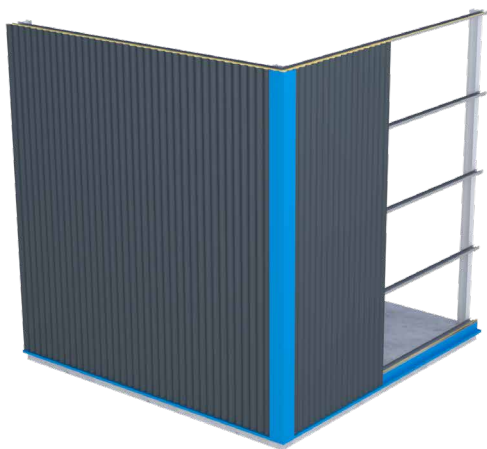

## Finishing 2 - Detail

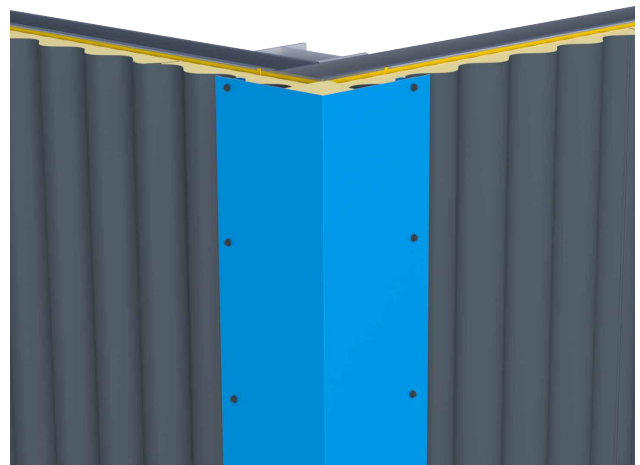

External flashing can be ordered with the same coating and colour as sandwich panels to promote the continuity of appearance. It is recommended to fix the external flashing to support with stitchers every 450 mm.

## Accessories

### Fasteners

#### Light steel section fasteners

Steel Purlin Thickness	Panel thickness (mm)	A2 Stainless Steel Fasteners	Carbon Steel Fasteners	A2 / Carbon
1,2 - 3,2 mm		Crown fixing 14	Crown fixing 14	Stitchers 2
	40	BM-CPLS115-S19-COL	CPLS115-S19-COL	(BM) ST22-S16-COL
	60	BM-CPLS135-S19-COL	CPLS135-S19-COL	
	80	BM-CPLS150-S19-COL	CPLS150-S19-COL	
	100	BM-CPLS180-S19-COL	CPLS175-S19-COL	
	120	BM-CPLS240-S19-COL	CPLS240-S19-COL	
	150	BM-CPLS240-S19-COL	CPLS240-S19-COL	

2 and 14 are the references presented on construction details

#### Heavy steel section fasteners

Steel Purlin Thickness	Panel thickness (mm)	A2 Stainless Steel Fasteners	Carbon Steel Fasteners	A2 / Carbon
4,0 - 12,5 mm		Crown fixing 14	Crown fixing 14	Stitchers 2
	40	BM-CPHS125-S19-COL	CPHS125-S19-COL	(BM) ST22-S16-COL
	60	BM-CPHS125-S19-COL	CPHS125-S19-COL	
	80	BM-CPHS150-S19-COL	CPHS150-S19-COL	
	100	BM-CPHS190-S19-COL	CPHS185-S19-COL	
	120	BM-CPHS190-S19-COL	CPHS245-S19-COL	
	150	BM-CPHS250-S19-COL	CPHS245-S19-COL	

2 and 14 are the references presented on construction details

### Sealants



Butyl tape air sealant 6 mm x 5 mm

High quality pressure sensitive butyl sealant  
Available in grey - 9,6 m a roll  
(reference 3 on construction details)



Butyl tape air sealant 9 mm x 5 mm

High quality pressure sensitive butyl sealant  
Available in grey - 6 m a roll  
(reference 5 on construction details)



Gun grade Mastic

High quality blend of rubber, fillers and  
polymer in gun-grade form.  
(reference 7 on construction details)



Fire rated foam insulation

High thermal performance insulation applied on  
site to reduce energy losses by thermal bridging.  
(reference 10 on construction details)



Profiled foam fillers

High quality Polyethylene fillers to fit the  
profile of JI Roof at the ridge.  
(reference 12 on construction details)

## Flashings and others

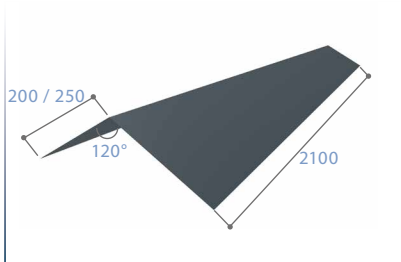

*Duopitch ridge internal flashing*

Same color and finish as inner sheet  
(Option for reference 4 on construction details)

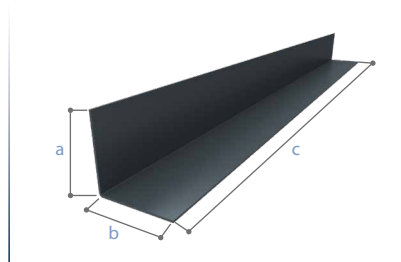

*Cleader angle -Structural*

Should be part of the structure and provided by others.  
(Option for reference 6 on construction details)

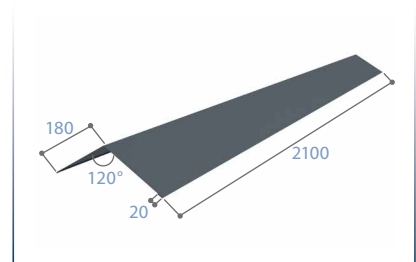

*Duopitch ridge external flashing (smooth)*

Same color and finish as outer sheet  
(Option for reference 11 on construction details)

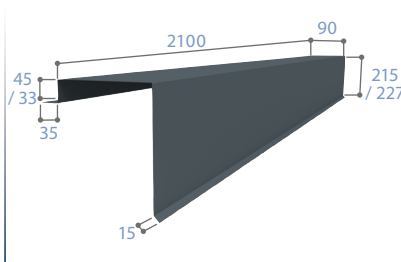

*Verge flashing*

Same color and finish as outer sheet  
(Option for reference 13 on construction details)

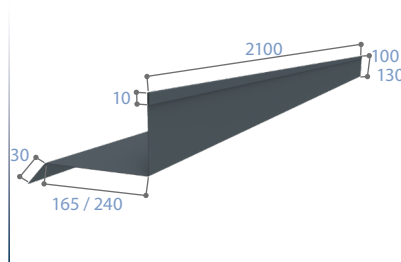

*Verge flashing against wall/parapet*

Same color and finish as outer sheet  
(Option for reference 13 on construction details)

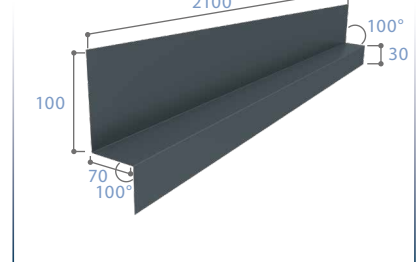

*Drip flashing*

Should be part of the structure and provided by others.  
(Option for reference 16 on construction details)

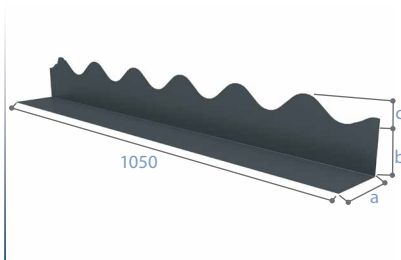

*Insulation cover flashing*

Same color and finish as outer/inner sheet



*Saddle washer*

Same color and finish as outer sheet

**All flashings are suitable to be customized.**

Joris Ide NV. is not responsible for printing errors and / or any differences between the images in this catalogue and the final product delivered. Joris Ide NV reserves the right to modify the technical specifications at any time without prior notice.







Jl Onduroof for all kind of projects.



Jl Onduroof PIR. for an agricultural building





**JORISIDE**  
THE STEEL FUTURE

**Joris Ide Ltd.**

A9, Elmbridge Court,  
Gloucester GL3 1JZ, United Kingdom

☎ +44 (0)1452 412 069

☎ +44 (0)1452 358 025

✉ [sales@jorisode.co.uk](mailto:sales@jorisode.co.uk)

**Joris Ide nv/sa**

Hille 174,  
8750 Zwevezele, Belgium

☎ +32 (0)51 61 07 77

☎ +32 (0)51 61 07 79

✉ [info@jorisode.be](mailto:info@jorisode.be)

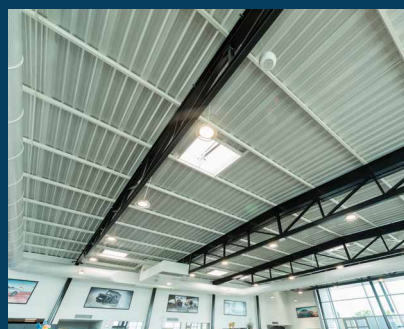

With more than 30 years of experience, Joris Ide represents a guarantee of quality in the construction market. We provide solutions in all fields: acoustic, aesthetic, fire, thermal. Joris Ide, the essential partner for all your projects.



**JORIS IDE IS  
PLANET  
PASSIONATE**



**MIX**  
Paper | Supporting  
responsible forestry  
**FSC® C010426**