



 **DUBLIN ROYAL**
CONVENTION CENTRE

Connecting
the future

We are the venue to
make connections, create
experiences, and inspire
guests to build their future



Immerse in event excellence

Dublin's newest meeting and events venue, the Dublin Royal Convention Centre delivers world-class gatherings and events.

Unveiled in 2022 at the new landmark Le Pole Square development, this area is also home to the renowned Radisson Blu Royal Hotel, Dublin and Velvære Spa.

Offering convenient, functional and flexible facilities, our venue can make your next event extraordinary, from private boardroom meetings to professional conferences of up to 800 people and gala banquets for 550 guests.

Dublin as an event destination



WELCOME



A warm welcome always awaits our local and international delegates from our dedicated hospitality team and event specialists.

As a world-class in destination meeting excellence, incentives, exhibitions and events, Dublin is a city renowned for creativity and innovation, where visitors feel at home and inspired. The city's personality is enthusiastic and open, and hosting your next event at the Dublin Royal Convention Centre will ensure you capture that same energy.

We take pleasure in bringing people from around the globe to the heart of Dublin to create memories, and shape the future. We look forward to welcoming you to the next chapter of meeting excellence.



Our passion for events and gatherings is what sets us apart.



A few of our key benefits:

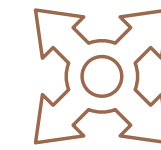

Over 2,020 sq.m of event space with capacity for over 1,100 delegates

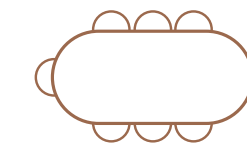

20 event spaces across the complex



Fully accessible venue

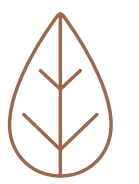

Sustainable venue

Collaborating with leaders in the meetings and events space, from hosts and planners to suppliers and partners, we offer a high standard of service across the board. Our experience is unrivalled in delivering professional and innovative events.



Delivering memorable moments



Offering customisation and personalisation along the way



Close to all public transport links and Dublin Airport



Gain rewards points for your event



Vibrant city-centre location



234 luxurious bedrooms located on-site



Complimentary high-speed Wi-Fi throughout the venue



A professional event specialist dedicated to you and your event, as well as a leading in-house team of AV & IT specialists



All catering prepared and cooked on-site by our culinary arts experts, using the finest Irish ingredients

Situated in the cultural quarter of Dublin and overlooking Dublin Castle, the Dublin Royal Convention Centre is in the heart of Dublin's transport hub, which is easily accessible by all public transport links, and is just 20 minutes from Dublin International Airport.

| To | Min | How |
|------------------|-------|-------|
| Dublin Bikes | 1 | Walk |
| Car Sharing | 1 | Walk |
| Dublin Bus | 3 | Walk |
| Connolly Station | 8 | Cycle |
| Heuston Station | 8 | Drive |
| Luas Green Line | 8 | Walk |
| Luas Red Line | 12 | Walk |
| Aircoach | 10-12 | Walk |
| Dublin Port | 20 | Drive |
| Airport | 20 | Drive |

From Q2 2022, there will be an Airport Flyer route to Dublin Airport that will have a pickup point at the hotel entrance, utilising 100% electric vehicles.

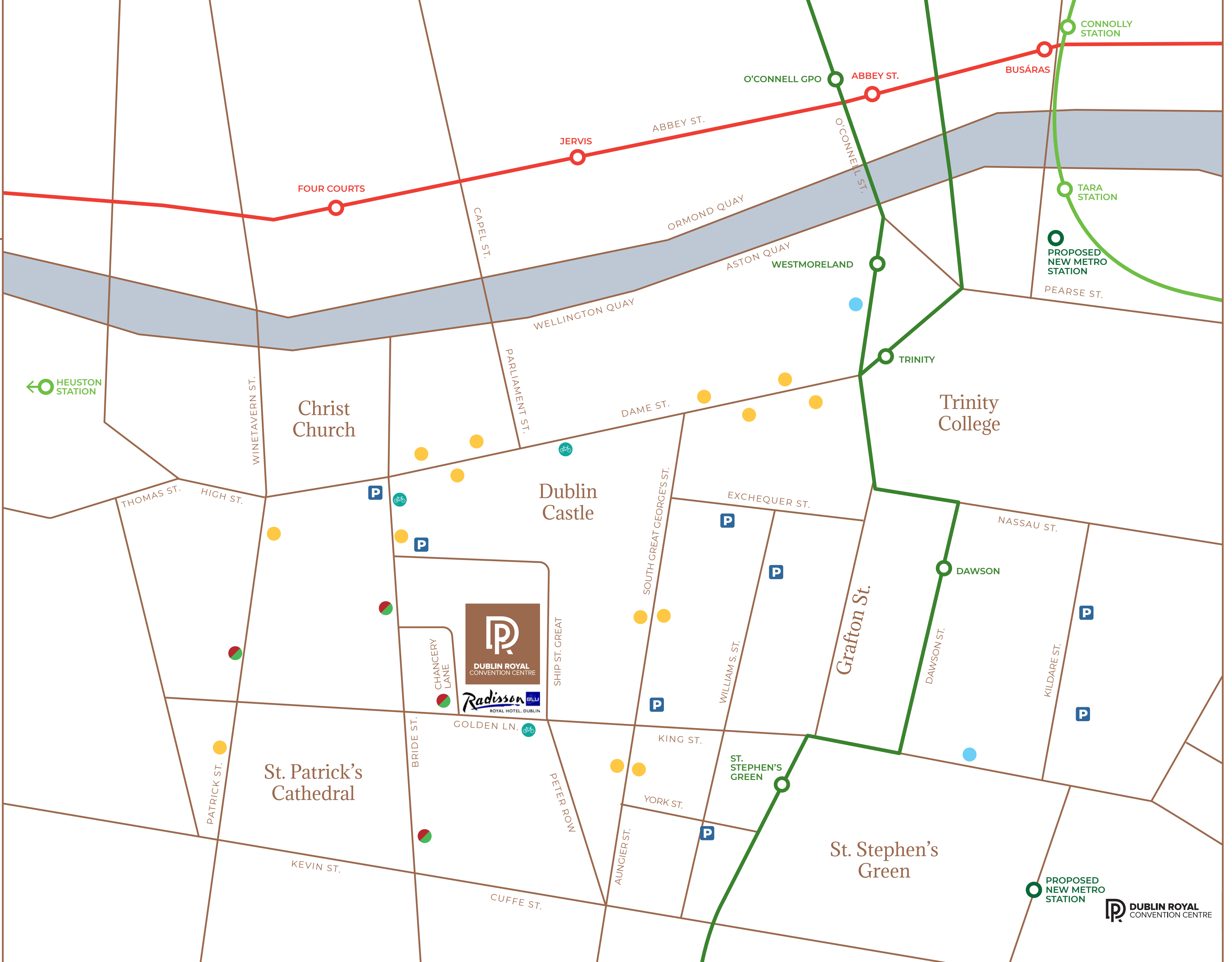

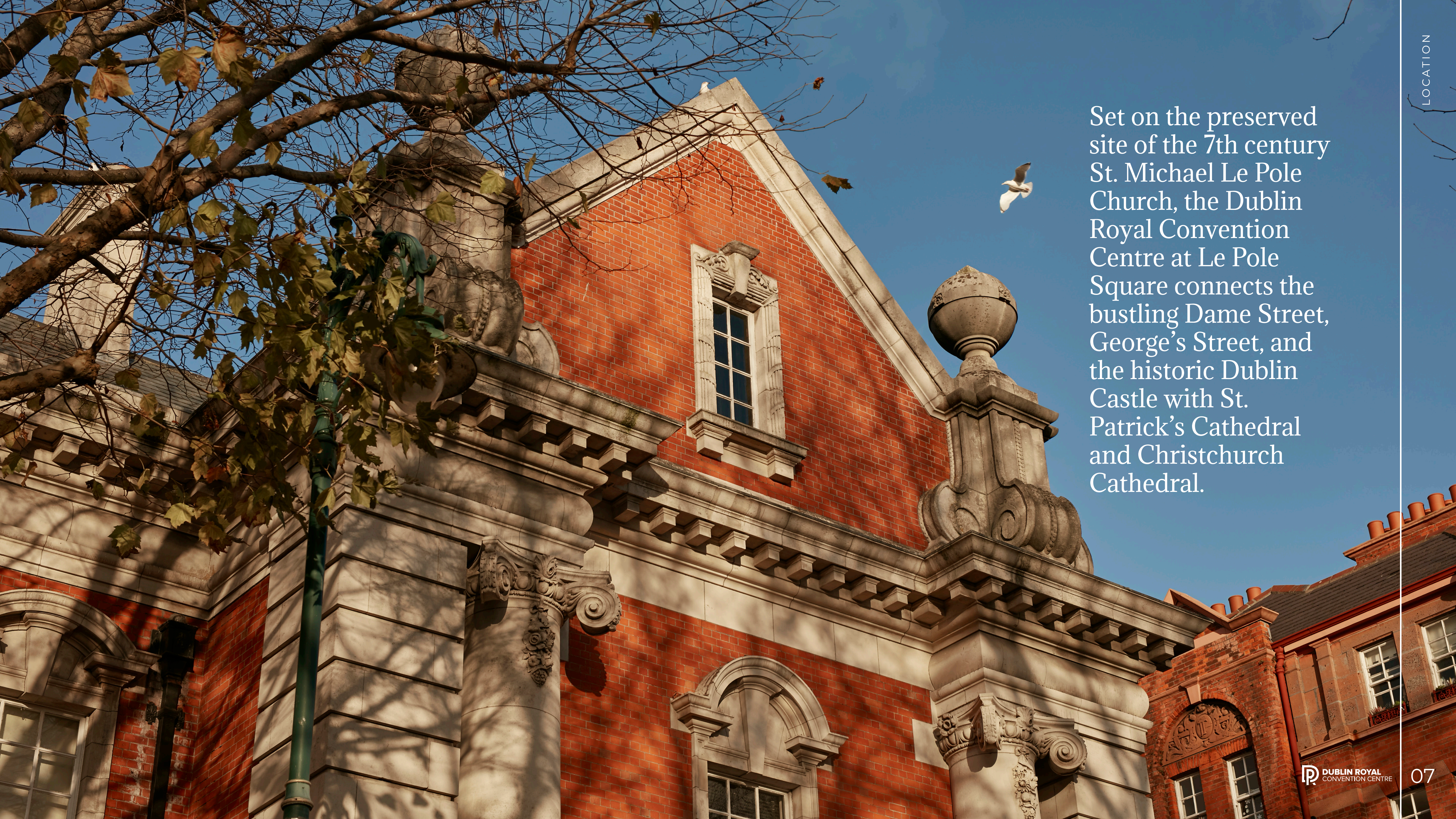

Set on the preserved site of the 7th century St. Michael Le Pole Church, the Dublin Royal Convention Centre at Le Pole Square connects the bustling Dame Street, George's Street, and the historic Dublin Castle with St. Patrick's Cathedral and Christchurch Cathedral.

Nestled in this cultural and historic quarter of the city, renowned for eateries and bars, our venue is inspired by the history of its location.

It features design elements that pay homage to the archaeological discoveries found on the site dating to Dublin's earliest Viking settlement.



Our 360° event offering

Set in Le Pole Square, the Dublin Royal Convention Centre and the Radisson Blu Royal Hotel, together offer unrivalled events & exhibition facilities.



A world-class event space, ideal for international and domestic business conferences, as well as exhibitions for up to 1,100 delegates.



THE ROBINSON SUITE



THE DOUGLAS HYDE SUITE

From meetings to shows and citywide celebrations, the Dublin Royal Convention Centre has three multi-functional event spaces over two floors that can be reconfigured to suit your needs.

The largest event space The Douglas Hyde suite: an 800-seater divisible and double-height conference room. Located on the lower ground floor, the suite spans over 704 sq. m, has a ceiling height of 7.7 m and state-of-the-art AV.

There are also five spacious suites on the upper ground floor, The Higgins Suite, The Robinson Suite and The Phoenix Suite, which allow for extra event space or flexibility. These can be used for breakout rooms, workshops, team building, exhibitions, or office space and offer natural daylight.

THE HIGGINS SUITE



The Douglas Hyde Suite

Lower Ground Floor

Suite 1 & 2 Capacity

| | |
|------------|------|
| Theatre | 800 |
| Banquet | 550 |
| Classroom | 400 |
| Cabaret | 378 |
| Exhibition | 1000 |

Suite 1 Capacity

| | |
|------------|-----|
| Theatre | 400 |
| Banquet | 270 |
| Classroom | 200 |
| Cabaret | 189 |
| Exhibition | 500 |

Suite 2 Capacity

| | |
|------------|-----|
| Theatre | 400 |
| Banquet | 270 |
| Classroom | 200 |
| Cabaret | 189 |
| Exhibition | 500 |

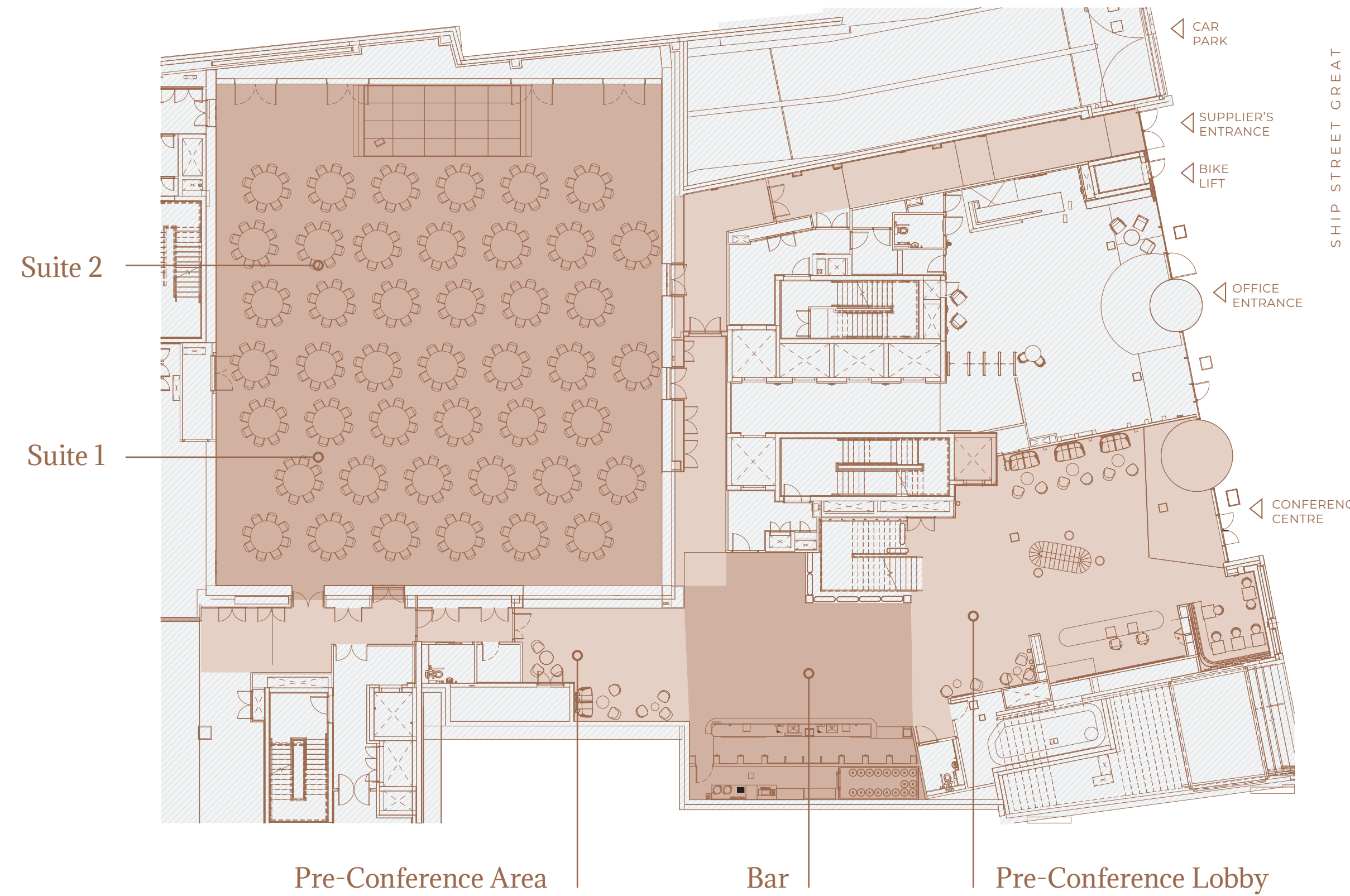

Named after Ireland's first President, The Douglas Hyde Suite can be divided into two suites and has been purposefully designed with large scale conferences, exhibitions & events in mind.

Location: Lower ground floor

Size: 704 sq.m

Ceiling height: 7.7m

Dividable: Yes

Natural Daylight: No

Screens & projectors: In-built

Air-conditioning: Yes

Free Wi-Fi: Yes

Pillars: No

Lobby: 391 sq. m preconference

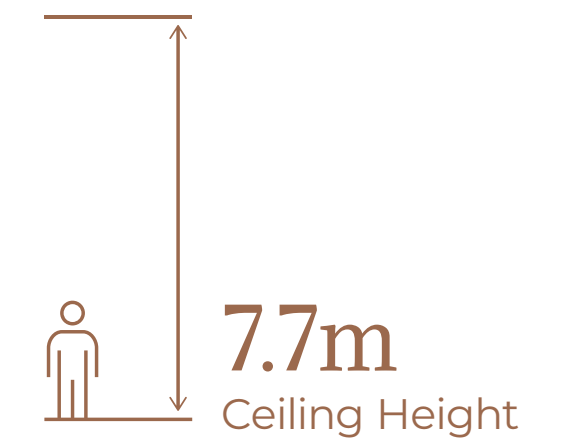

The Robinson Suite

Upper Ground Floor

Suite 1 & 2 Capacity

| | |
|------------|-----|
| Theatre | 110 |
| Banquet | 100 |
| Classroom | 90 |
| Cabaret | 70 |
| Exhibition | 170 |

Suite 1 Capacity

| | |
|------------|----|
| Theatre | 55 |
| Classroom | 45 |
| Cabaret | 35 |
| Exhibition | 85 |

Suite 2 Capacity

| | |
|------------|----|
| Theatre | 55 |
| Classroom | 45 |
| Cabaret | 35 |
| Exhibition | 70 |

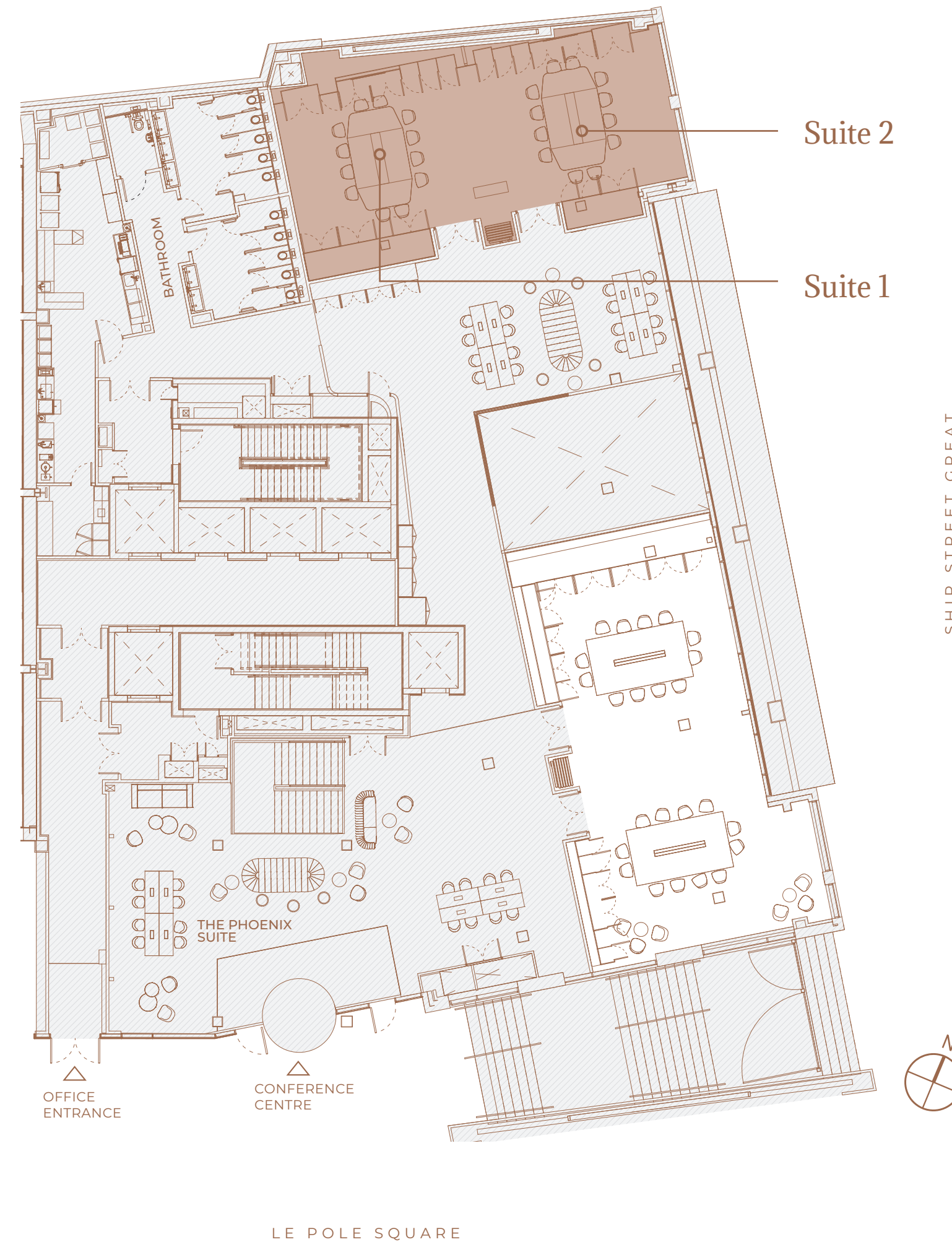

The Robinson Suite is named after Ireland's first female President & former United Nations High Commissioner for Human Rights. This space offers flexible event set ups and also overlooks Ship Street & Dublin Castle.

Location: Upper ground floor

Size: 108 sq. m

Ceiling height: 3.2 m

Dividable: Yes

Natural daylight: Yes

Screens & projectors: In-built

Air-conditioning: Yes

Free Wi-Fi: Yes

Pillars: No

Lobby: 277 sq. m / Breakout area

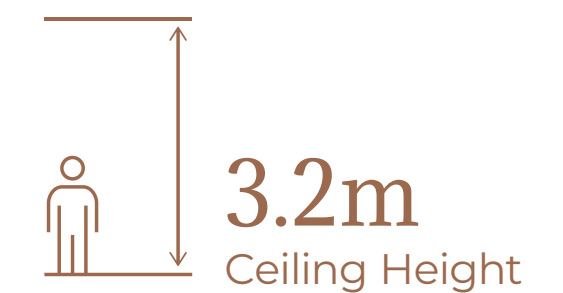

The Higgins Suite

Upper Ground Floor

Suite 1 & 2 Capacity

| | |
|------------|-----|
| Theatre | 160 |
| Banquet | 90 |
| Classroom | 80 |
| Cabaret | 63 |
| Exhibition | 150 |

Suite 1 Capacity

| | |
|------------|----|
| Theatre | 80 |
| Classroom | 40 |
| Cabaret | 35 |
| Exhibition | 80 |

Suite 2 Capacity

| | |
|------------|----|
| Theatre | 80 |
| Classroom | 40 |
| Cabaret | 28 |
| Exhibition | 70 |

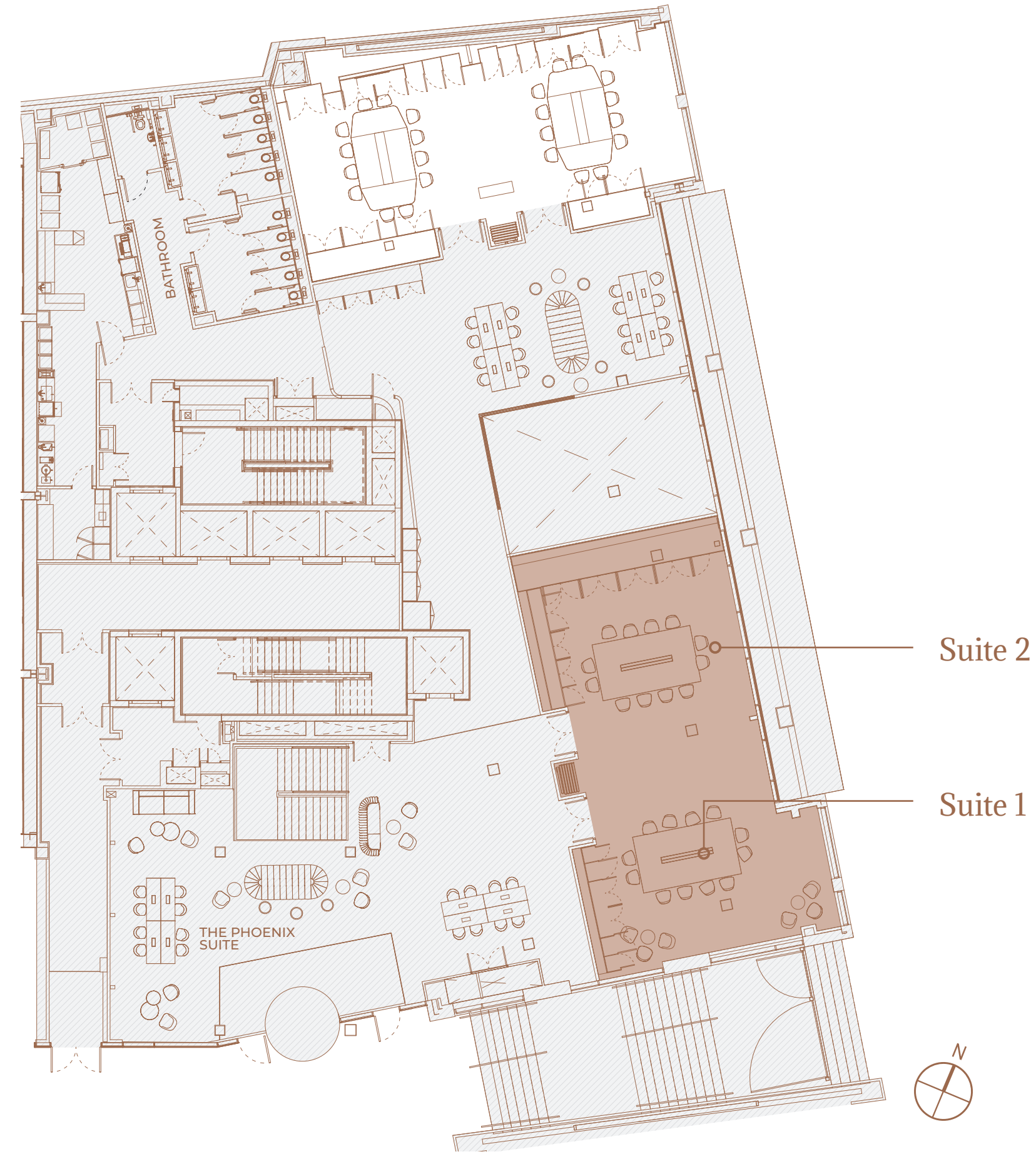

The Higgins Suite, dedicated to our current President, can accommodate a variety of set up styles and enjoy natural daylight with views overlooking Dublin Castle.

Location: Upper ground floor

Size: 129 sq.m

Ceiling height: 3.2m

Dividable: Yes

Natural daylight: Yes

Screens & projectors: In-built

Air-conditioning: Yes

Free Wi-Fi: Yes

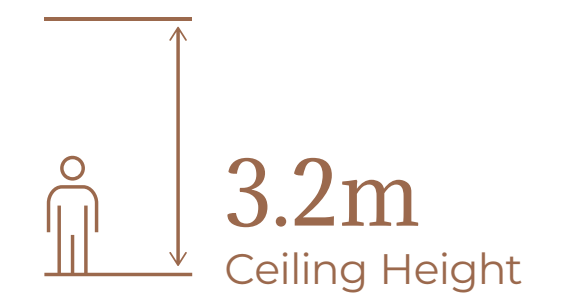

Pillars: No

Lobby: 277 sq.m / Breakout area





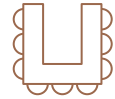
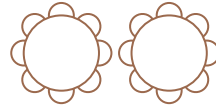
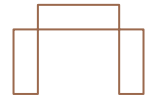
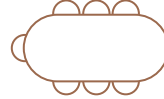

Dublin Royal Convention Centre

Capacity Chart

| Meeting Room | Location | Floor Area (m ²) | Length & Width (m) | Ceiling Height (m) | Maximum Capacity |  Theatre |  Classroom |  Cabaret Tables of 8 |  U Shape |  Banquet Rounds of 10 |  Reception |  Boardroom |
|-----------------------------------|-----------------------|------------------------------|--------------------|--------------------|------------------|---|---|---|---|--|---|---|
| The Douglas Hyde Suite 1+2 | Lower Ground Floor | 705 | 25 x 28 | 8 Highest Point | 1,000 | 800 | 370 | 384 | - | 550 | 1000 | - |
| The Douglas Hyde Suite 1 | Lower Ground Floor | 351 | 25 x 14 | 8 Highest Point | 500 | 400 | 185 | 192 | - | 270 | 500 | - |
| The Douglas Hyde Suite 2 | Lower Ground Floor | 347 | 25 x 14 | 8 Highest Point | 500 | 400 | 185 | 192 | - | 270 | 500 | - |
| Breakout Area | Lower Ground Floor | 391 | - | 3 | - | - | - | - | - | - | - | - |
| The Higgins Suite 1+2 | Upper Ground Floor | 129 | 8 x 16 | 3 | 160 | 160 | 90 | 80 | 36 | 100 | 160 | - |
| The Higgins Suite 1 | Upper Ground Floor | 64 | 8 x 8 | 3 | 80 | 80 | 45 | 40 | 18 | 50 | 80 | - |
| The Higgins Suite 2 | Upper Ground Floor | 64 | 8 x 8 | 3 | 80 | 80 | 45 | 40 | 18 | 50 | 80 | - |
| The Robinson Suite 1+2 | Upper Ground Floor | 108 | 7 x 17 | 3 | 110 | 110 | 72 | 48 | 33 | 80 | 110 | - |
| The Robinson Suite 1 | Upper Ground Floor | 53 | 6 x 8 | 3 | 55 | 55 | 36 | 24 | 16 | 40 | 55 | - |
| The Robinson Suite 2 | Upper Ground Floor | 54 | 6 x 8 | 3 | 55 | 55 | 36 | 24 | 16 | 40 | 55 | 16 |
| The Phoenix Suite | Upper Ground Floor | 47 | 10 x 5 | 3 | 20 | - | - | - | - | - | - | - |
| Breakout Area | Upper Ground Floor | 277 | - | 3 | - | - | - | - | - | - | - | - |
| Le Pole Square | External Ground Floor | 1,090 | 33 x 30 | - | - | - | - | - | - | - | - | - |

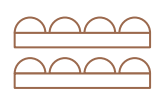
Radisson Blu Royal Hotel

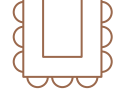
Capacity Chart

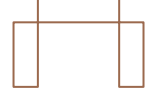
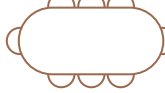
| Meeting Room | Location | Floor Area (m ²) | Length & Width (m) | Ceiling Height (m) | Maximum Capacity |  Theatre |  Classroom |  Cabaret Tables of 8 |  U Shape |  Banquet Rounds of 10 |  Reception |  Boardroom |
|------------------------------|----------------------|------------------------------|--------------------|--------------------|------------------|---|---|---|---|--|---|---|
| Goldsmith Hall 1+2+3 | Ground Floor | 348 | 29 x 12 | 4 | 500 | 400 | 240 | 161 | - | 270 | 500 | - |
| Goldsmith Hall 1 + 2 | Ground Floor | 208 | 12 x 17 | 4 | 240 | 240 | 144 | 90 | 53 | 150 | 240 | - |
| Goldsmith Hall 2 + 3 | Ground Floor | 240 | 12 x 20 | 4 | 264 | 264 | 150 | 112 | 65 | 180 | 260 | - |
| Goldsmith Hall 1 | Ground Floor | 108 | 12 x 9 | 4 | 112 | 112 | 72 | 42 | 33 | 80 | 110 | - |
| Goldsmith Hall 2 | Ground Floor | 99 | 12 x 8 | 4 | 112 | 112 | 66 | 42 | 33 | 80 | 110 | - |
| Goldsmith Hall 3 | Ground Floor | 140 | 12 x 12 | 4 | 168 | 168 | 90 | 70 | 36 | 100 | 150 | - |
| The Writers Room | Ground Floor | 40 | 7 x 6 | 4 | 12 | - | - | - | - | - | - | - |
| Swift Suite 1 + 2 | First Floor | 81 | 8 x 10 | 3 | 80 | 80 | 64 | 42 | 26 | 50 | 80 | - |
| Swift Suite 1 | First Floor | 34 | 8 x 4 | 3 | 25 | 25 | 24 | 18 | 16 | 12 | 35 | - |
| Swift Suite 2 | First Floor | 46 | 8 x 6 | 3 | 50 | 50 | 40 | 24 | 24 | 32 | 50 | - |
| Field Suite 1 & 2 | First Floor | 65 | 7 x 8 | 3 | 70 | 70 | 56 | 42 | 26 | 40 | 60 | - |
| Field Suite 1 | First Floor | 33 | 7 x 4 | 3 | 30 | 30 | 24 | 18 | 15 | 12 | 30 | - |
| Field Suite 2 | First Floor | 31 | 7 x 4 | 3 | 30 | 30 | 24 | 18 | 19 | 12 | 30 | - |
| Pearse Boardroom | First Floor | 48 | 8 x 6 | 3 | 16 | - | - | - | - | - | - | - |
| Connolly Boardroom | First Floor | 40 | 7 x 6 | 3 | 12 | - | - | - | - | - | - | - |
| Emmet Boardroom | First Floor | 34 | 9 x 4 | 3 | 12 | - | - | - | - | - | - | - |
| Sky Suite 1+2 | Seventh Floor | 111 | 16 x 5 | 3 | 50 | 50 | 35 | 28 | 24 | 40 | 50 | - |
| Sky Suite 1 | 7th Floor | 43 | 8 x 5 | 3 | 25 | - | - | - | - | - | 25 | 12 |
| Sky Suite 2 | 7th Floor | 68 | 12 x 5 | 3 | 25 | 50 | 35 | 28 | 24 | 40 | 25 | 16 |
| Dyflin Garden Terrace | External First Floor | 217 | 14 x 15 | - | 150 | - | - | - | - | - | 150 | - |
| 5th Floor Terrace | External Fifth Floor | 73 | 20 x 4 | - | 50 | - | - | - | - | - | 50 | - |
| 6th Floor Terrace | External Sixth Floor | 162 | 32 x 5 | - | 100 | - | - | - | - | - | 100 | - |



We couple our world-class facilities with the latest technology to produce the best possible event experience, ensuring peace of mind for our planners.

As well as high-speed Wi-Fi, our meeting spaces offers the latest presentation technologies with large format full HD projection systems.

Our in-built high-quality audio systems also ensure evenly distributed sound throughout. The Douglas Hyde Suite, has an in-built trussing system, a customisable stage and creative LED lighting. It also boasts an automated lighting and gobo rig as well as acoustic wall treatments and reconfigurable furniture, stage and prop storage facilities.

Our on-site AV team can assist with any technology requirements and help turn your event into a memorable and inspiring occasion.

Our venue as your virtual meeting base makes it easy to create events that reach and engage a wide range of participants.



With our industry-leading in-house audio-visual partner, we offer state of the art technology and event innovations that allow us to extend event experiences to your participants, no matter where they are.

Thanks to our spaces and technologies, each delegate can fully immerse and contribute. You are no longer limited. You can embrace the virtual and hybrid world, break down barriers, and take your event to a new level.

Our dedicated experts can help create live and virtual breakout rooms, with striking backdrops and exhibition areas, sponsor visibility, interaction and networking opportunities, ensuring all delegates feel connected. Simply log in with your preferred video conferencing service and leave the rest to our team.



Known as the island of a hundred thousand welcomes, this reputation shines through in the friendly and professional service we provide.

From the moment you arrive to the time we say goodbye, our team will provide you with the best experience and lasting memories.

Driven by our mission to help shape the future of Dublin, we are guided by the leadership of CEO Madeline Riley, whose passion it is to ensure your time with us is enjoyable and memorable.

We grow talent, and talent grows us. With our team, anything is possible.



Our Executive Chef, has designed menus that are fresh, vibrant, on trend and, of course, full of flavour. Using local produce, we deliver a food offering that reflects Dublin city and the beautiful island of Ireland.

We strive to exceed your food and beverage expectations. Providing diverse and expertly prepared menus that ensure every detail is just as you want it, each dish is creatively presented by our highly skilled chefs. Whether it's a business breakfast, a working lunch, buffet, canapés, sharing plates or a sit-down dinner, our teams work closely with local artisan producers to source the best in homegrown produce to create a truly unforgettable experience, be it a traditional Irish dish or a contemporary meal with flavours from around the world.

Recognised as Ireland's gastronomic capital, we are proud of the quality of food produced in Dublin and this is reflected in our event catering options.

The adjacent Radisson Blu Royal Hotel is one of Dublin's most popular hotels - thanks to its unparalleled city centre location, meeting and conferences spaces, bedroom accommodation, food and beverage and great service.



The neighbouring Radisson Blu Royal Hotel, Dublin is a sister property of the Dublin Royal Convention Centre and is one of Dublin's most popular hotels - thanks to its meeting and conference spaces, excellent accommodation, food and service.

A few key features of the Radisson Blu Royal Hotel, Dublin:

Goldsmith Hall

The multifunctional Goldsmith Hall conference space can cater for 400 people theatre-style and 270 for a gala banquet. This versatile space can host many event options with partition walls that can divide it into three sections, with a large pre-function area for exhibition space and networking. As well as offering natural daylight, the Goldsmith Hall has in-built AV.

Meeting Spaces

The dedicated 1st floor meeting space can cater for boardroom meetings of 10 to 80 delegates theatre-style. The 7 meeting rooms here are perfect for smaller meetings, breakout rooms for workshops or for exhibition space. All meeting rooms have in-built plasma screens, or screen and projector, natural daylight, and air conditioning.

Sky Suite

The hotel is also home to the Sky Suite on the 7th floor and offers stunning panoramic views of Dublin's skyline. With wrap-around balconies, a private bar and lift, the Sky Suite is the perfect location for intimate post-conference drinks or dinner for up to 50 of your guests.

Dyflin Garden Terrace

The Dyflin Garden Terrace on the 1st floor is the ideal hideaway for a BBQ for up to 100 people. Soak up the ambiance of city life and enjoy party food & cocktails.



The hotel also boasts the renowned Chancery Grill and the beautiful Velvære Spa that offers treatment rooms and a thermal suite for delegates down time.



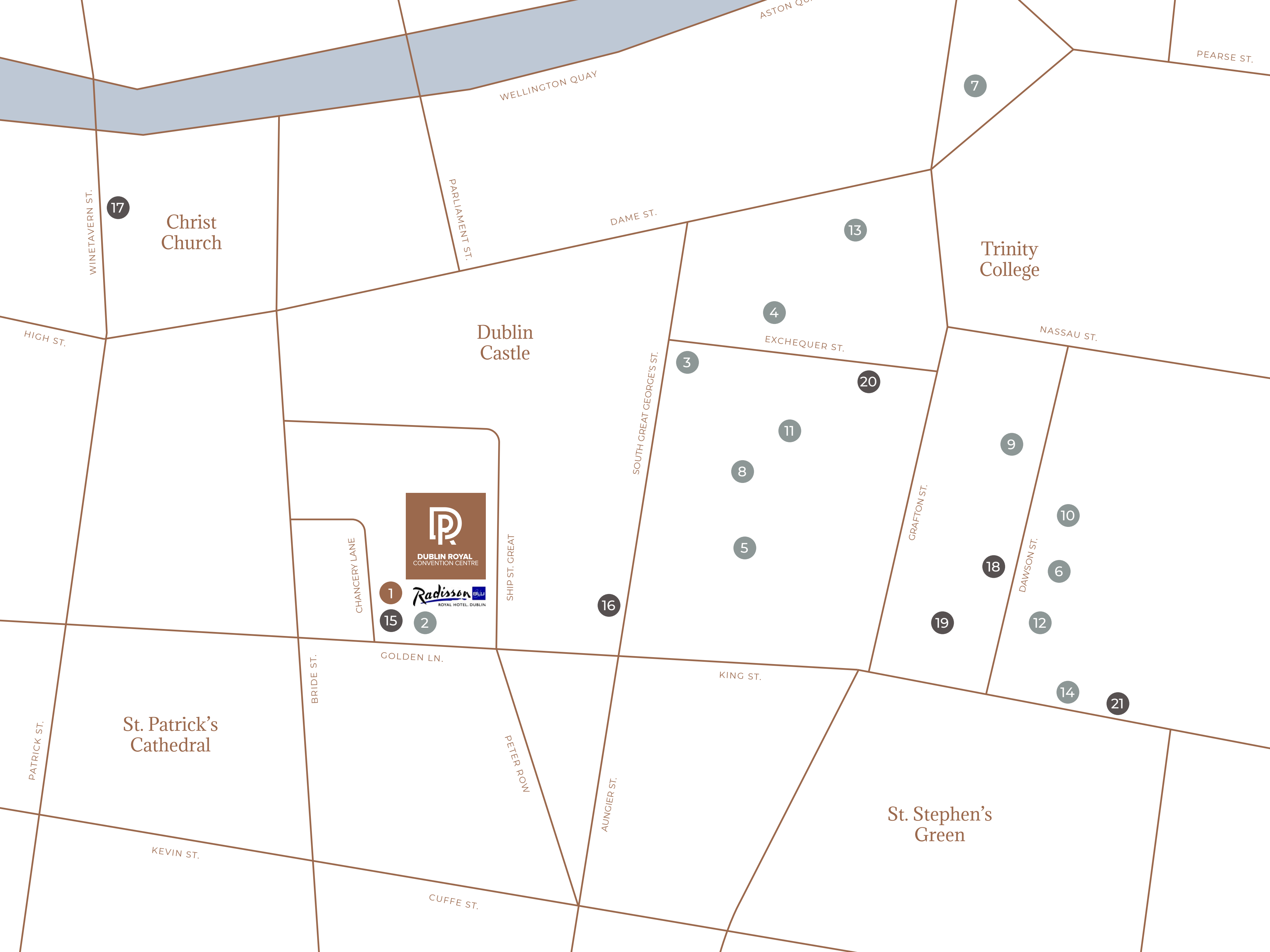

To Relax

- 1 Velvære Spa



To Dine

- 1 The Chancery Grill
- 3 Rustic Stone
- 4 Fallon & Byrne
- 5 Fade Street Social
- 6 FIRE Steakhouse & Bar
- 7 Medley
- 8 The Market Bar
- 9 Marco Pierre White Steakhouse & Grill
- 10 The Ivy Dublin
- 11 SOLE Seafood & Grill
- 12 Six by Nico Dublin
- 13 Pichet
- 14 Peploe's St Stephen's Green



To Drink

- 15 The Dyflin Bar
- 16 Long Hall
- 17 Brazen Head
- 18 Café en Seine
- 19 Zozimus Bar
- 20 Dakota
- 21 Ely Wine Bar

Within walking distance of the complex

- Guinness Storehouse & Open Gate Brewery
- Jameson Distillery Bow St.
- Pearse Lyons Distillery
- Teeling Whiskey Distillery
- Roe & Co Distillery
- The Dublin Liberties Distillery
- Irish Whiskey Museum

Our focus is always on doing the right thing by our guests, and the environment.



A first class venue with NZEB standards, the Dublin Royal Convention Centre operates to achieve more sustainable and greener initiatives to safeguard the environment.

Sustainability is at the heart of this A2 energy efficient building, offering bicycle bays, smart car charging points, PV panels, highly-efficient LED fittings, and energy-efficient systems.

The Dublin Royal Convention Centre also guarantees the full carbon offset of all their meetings and events taking place, at zero costs to our clients.

Selecting partners and suppliers who support green initiative is our goal at all times.



A historical civic square built to inspire you

Le Pole Square respects the past and embraces the future.

A landscaped civic square with the excavated remains of St. Michael Le Pole Church, is the focal point of the scheme. Once St. Michael of the Pool, due to the round tower overlooking the 'Black Pool' or Dubh Linn in Irish, from which Dublin takes its name. The great storm of 1775 did irreparable damage to the tower eventually leading to the church being pulled down.

Inspired by its history, this LEED Gold building keeps the name Le Pole alive encouraging visitors to reflect on this medieval legacy. Multifunctional in nature, this public space offers an immersive cultural experience. The garden is landscaped with tiles replicating designs taken from the church interior. This space gives visitors a social meeting place with a spa, café and gallery.



Meet in the heart of Dublin



For further information please call
our team of event specialists.

+353 1 8982933

The Dublin Royal Convention Centre
1 Le Pole Square, Chancery Lane, Ship Street Great
Dublin 8, D08 E6PD, Ireland

info@meetingsindublin.com

www.dublinroyalconventioncentre.com

[@dublinroyalconventioncentre](#)